

**ELLIET<sup>®</sup>**

MANUAL

# Edge Styler



You will find information about the actual use and maintenance of the machine in this booklet. **Read it carefully and keep it in a safe place.**



Please also keep your **purchasing invoice** or the proof of receipt together with this booklet.



**Register** your product online at **[www.elieta.eu](http://www.elieta.eu)**

ELIET

Copyright 2009 ELIET. All rights reserved. All textual material, drawings, figures, diagrams, graphs, etc., included in this ELIET booklet are protected by copyright and also by other intellectual property rights. Nothing from this information may be copied for commercial goals or distributed and/or changed or reposted for other goals. Content has been included at specific places in this ELIET manual of which the copyright is the exclusive property of their respective owners.

# 1. Introduction

---



## 1.1 Carefully read this user manual

---

ELIET machines are designed for safe and reliable use if they are operated in accordance with the instructions given. Carefully read these operating instructions before using the machine. Failure to observe this may result in personal injury or damage to the equipment.

## 1.2 Identification Data - ELIET EDGE STYLER STD/PRO

---

Note the identification data relating to your machine in the boxed areas:

Stock No.:	<input type="text" value="MA"/>
Serial number:	<input type="text"/>
Year of Manufacture:	<input type="text" value="20"/>

# 2. Warranty

---



## 2.1 Warranty card

---

To be eligible to obtain warranty you must mail the completed warranty card within one month of the date of purchase to the address stated below:

European customers:  
 ELIET EUROPE NV,  
 Diesveldstraat 2,  
 B - 8553 Otegem (België)  
 Tel. +32 56 77 70 88  
 Fax +32 56 77 52 13

US customers:  
 ELIET USA Inc.  
 3361 Stafford Street (office B)  
 15204 Pittsburgh (PA)  
 Tel: 412 367 5185  
 Fax: 412 774 1970

**REGISTER YOUR PRODUCT ONLINE AT [WWW.ELIET.EU](http://WWW.ELIET.EU)**

Read the warranty conditions on the attached warranty card.

## 3. Welcome

---



### **Welcome to the family of ELIET users.**

We would like to thank you for the confidence that you have placed in ELIET and we are convinced that you have purchased the very best machine. The operating life of your ELIET machine depends to a great extent on how you care for your machine. If you follow the instructions and suggestions in these manuals, your ELIET machine will operate for a very long time in optimal condition.

Read this instruction manual carefully before operating this machine. This will prevent you from operating the device incorrectly. For your own safety, take into account the safety instructions specified in the relevant chapter. Even if you are thoroughly familiar with operating such equipment, it is still advisable to read these pages carefully.

At ELIET all our machines and devices are subjected to a policy of continuous change and therefore, the specification of your machine may differ slightly in terms of shape, technology and accessories. The descriptions and technical data in this manual are accurate at the time of printing. Certain illustrations and descriptions may not be applicable to your specific machine, but instead relate to a different version of the machine. In turn, we trust that you will understand that the texts and illustrations in this manual cannot lead to any claims. If you still have any questions after you have read this manual, please contact your ELIET dealer. Find an official ELIET dealer near you at [www.eliyet.eu](http://www.eliyet.eu).

## **ELIET AT YOUR SERVICE**

During office hours our help desk will make every effort to answer your questions :

### Europese klanten

GMT +1: van 8.00 u tot 18.00 u

Tel: +32 56 77 70 88

Fax: +32 56 77 52 13

[Service@eliyet.be](mailto:Service@eliyet.be)

### US customers

GMT -6: from 8AM to 6PM

Tel: 412 367 5185

Fax: 412 774 1970

[service@eliyetmachines.com](mailto:service@eliyetmachines.com)

## 4. Table of Contents

---

<b>1. Introduction</b> .....	<b>3</b>
1.1 Carefully read this operating instruction manual .....	3
1.2 Identification Data - ELIET Edge Styler STD/PRO .....	3
<b>2. Warranty</b> .....	<b>3</b>
2.1 Warranty card .....	3
<b>3. Welcome</b> .....	<b>4</b>
<b>4. Table of Contents</b> .....	<b>5</b>
<b>5. Operator safety warnings</b> .....	<b>7</b>
5.1 For your information .....	7
5.2 Caution.....	7
5.3 Warning.....	7
<b>6. Main parts</b> .....	<b>8</b>
6.1. Machine.....	8
6.2 Motor .....	9
6.3 Set-up.....	10
<b>7. Safety instructions</b> .....	<b>11</b>
7.1 Safety messages.....	11
7.2 Safety features .....	13
7.3 Safety instructions.....	15
7.3.1 General safety regulations.....	15
7.3.2 Careful and proper use.....	15
7.3.3 Responsibilities of the operator .....	16
7.3.4 Personal Protective Equipment (PPE) .....	17
7.3.5 Danger zone.....	17
7.3.6 Periodic maintenance .....	18
7.3.7 Limits of the machine .....	19
7.3.8 In harmony with nature.....	20
<b>8. Dealer preparation</b> .....	<b>21</b>
8.2 Parts included .....	22
8.2 Assembly instructions Edge Styler STD.....	23
8.3 Assembly instructions Edge Styler PRO.....	25
8.4 Preparing the machine for use .....	25
<b>9. Operating instructions</b> .....	<b>27</b>
9.1 Preliminary checks .....	27
9.2 Preparing the work area .....	28
9.2.1 Plotting out a reference path .....	28
9.2.2 Achieving quality results by preventing damage.....	29
9.3 Starting and stopping the motor .....	29
9.3.1 Starting the motor.....	29
9.3.2 Stopping the motor .....	31
9.4 Operating the machine .....	31

<b>9.4 Operating the machine</b> .....	<b>31</b>
9.4.1 Principles of operation .....	31
9.4.2 Thrusting the blade into the ground .....	33
9.4.3 Operating the machine .....	34
9.4.4 Checking oil and petrol levels .....	36
9.4.5 Activating the anti-deviation disc .....	36
9.4.6 Adding extra tail weight .....	37
9.4.7 Adjusting the steering (Edge Styler Pro) .....	37
<b>9.5 Troubleshooting</b> .....	<b>38</b>
9.5.1 Motor fails to start after idle periods .....	38
9.5.2 Motor shuts off whilst in use .....	39
9.5.3 Problems with the blade driver .....	40
<b>10. Transporting the machine</b> .....	<b>42</b>
<b>11. Maintenance</b> .....	<b>44</b>
11.1 General .....	44
11.2 Maintenance schedules .....	45
11.2.1 Special maintenance .....	45
11.2.2 Periodic maintenance schedule .....	45
11.3 Cleaning the machine .....	47
11.3.1 The importance of cleaning .....	47
11.3.2 What does cleaning mean? .....	47
11.4 Maintenance procedures .....	49
11.4.1 Motor maintenance .....	49
11.4.2 Machine maintenance .....	54
11.5 General lubrication treatment .....	62
11.5.1 Lubricants .....	62
11.5.2 Thorough lubrication using the lubricating nipples provided .....	63
11.5.3 Lubricating hinges and contact points prone to friction .....	63
11.5.4 Lubricating the bearing .....	63
<b>12. Winterizing the machine</b> .....	<b>65</b>
<b>13. Extra equipment</b> .....	<b>66</b>
<b>14. Hazard analysis</b> .....	<b>69</b>
<b>15. Warranty conditions</b> .....	<b>70</b>
<b>16. EC Declaration of Conformity</b> .....	<b>73</b>
<b>17. Equipment specifications</b> .....	<b>74</b>

## 5. Operator safety warnings

ELIET cannot foresee every situation in which a risk or danger can occur. The warnings in this user manual, the labels on the machine are therefore, not comprehensive. Even though this will be minimal, a residue risk will always be present. If you apply a working method, action or technique as the user that is not explicitly recommended by ELIET, ensure in any case that this will not represent a danger for bystanders.



A number of symbols ("For your information", "Caution", "Warning") are used in this user manual to provide additional information and to highlight dangers.

### 5.1 For your information



#### **For your information :**

This symbol is used to draw your attention to specific information and/or actions, or to denote where you can find additional information relating to the subject.

### 5.2 Caution



#### **Caution :**

This notice identifies safe usage habits. This is done to prevent incorrect actions that can result in personal injury or damage to the machine.

### 5.3 Warning



#### **Warning :**

This notice is used to warn you about extreme danger that you must be aware of in these specific circumstances. Thus remain alert, in order to ensure your own safety.

These safety measures can only warn and not remove the danger. Using common sense and observing the guidelines contained in this manual are essential to prevent accidents.

## 6. Main parts

To fully understand the content of this operator's manual you need to be fully conversant with the terminology used for the descriptions. In this chapter you can find a set of parts identified by name. It is a good idea to take time to study the machine beforehand for an improved understanding of the descriptions provided in this user manual.

### 6.1. Machine

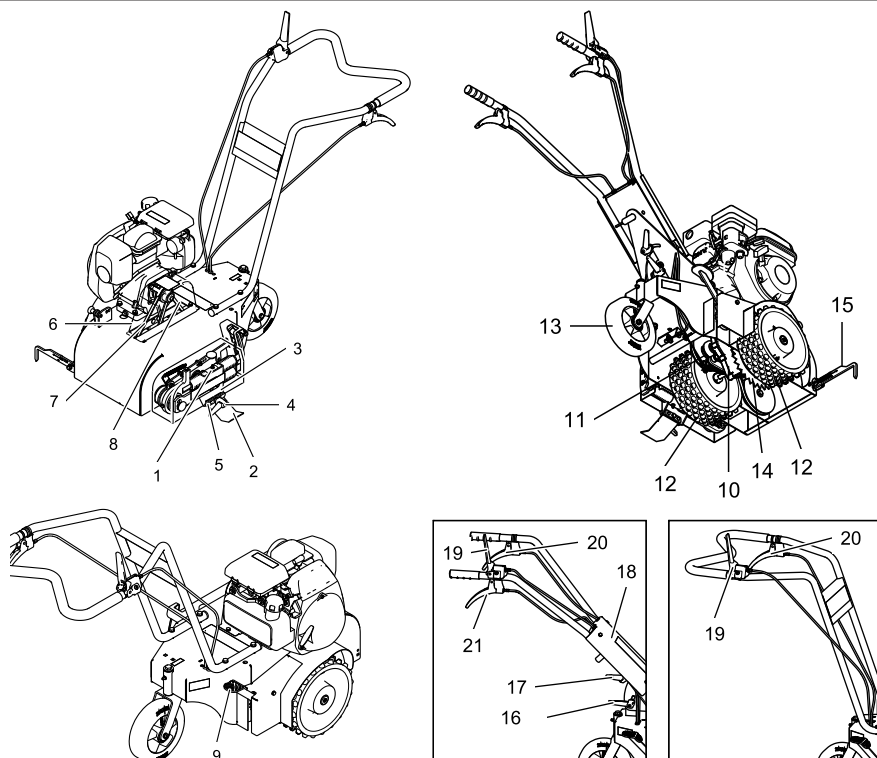

- |   |   |
|---|---|
| <b>1)</b> Blade arm                       | <b>12)</b> Studded wheels                         |
| <b>2)</b> Blade*                          | <b>13)</b> Swivel caster                          |
| <b>3)</b> Blade holder                    | <b>14)</b> Anti-deviation disc (PRO)              |
| <b>4)</b> Blade tightening bolt           | <b>15)</b> Edging guide (PRO)                     |
| <b>5)</b> Blade locking mechanism         | <b>16)</b> Height adjustment (PRO)                |
| <b>6)</b> Belt shield                     | <b>17)</b> Angling adjustment (PRO)               |
| <b>7)</b> Drive belt for the blade        | <b>18)</b> Anti-vibration dampers (PRO)           |
| <b>8)</b> Drive belt for the wheel drive  | <b>19)</b> Clutch lever front-wheel drive         |
| <b>9)</b> Pedal with ratcheting mechanism | <b>20)</b> Lever for releasing the blade arm lock |
| <b>10)</b> Transmission box               | <b>21)</b> Control lever for managing speed       |
| <b>11)</b> Variomatic (PRO)               | (PRO)   |



## 6.2 Motor

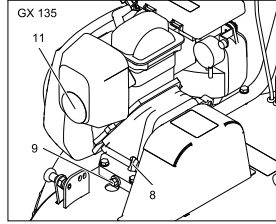
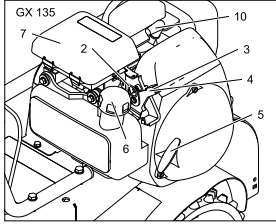
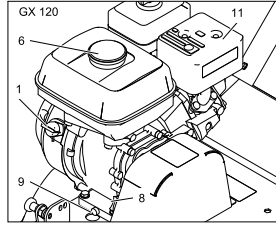
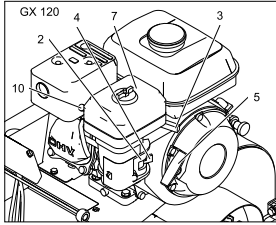

- |                          |                   |
|--------------------------|-------------------|
| 1) Start and stop switch | 7) Air filter     |
| 2) Throttle (choke)      | 8) Oil filler cap |
| 3) Thrust lever          | 9) Oil drain plug |
| 4) Fuel tap              | 10) Spark plug    |
| 5) Recoil starter        | 11) Exhaust       |
| 6) Petrol filler cap     |                   |

\*(for an overview of the selection of blade types, see chapter 13)  
The machine can be slightly different from the figure.



### For your information:

References in this manual to the right- or left-hand side, back or front, are viewed from the working-position of the operator, behind the handle-bar.

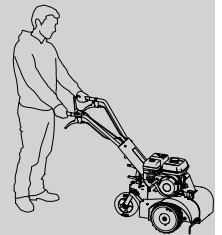

### For your information:

Your ELIET dealer is at your service, ready to provide you with maintenance or advice so that your ELIET machine always remains in optimal condition. Original ELIET parts and lubricants can be obtained from your ELIET dealer. These service parts are manufactured to the same stringent accuracy requirements and standard of craftsmanship as the original equipment. (Find your nearest dealer by visiting [www.elieta.eu](http://www.elieta.eu))



**Caution:**

For your safety, use only genuine ELIET parts on ELIET machines. The list of original replacement parts and their ordering code can be consulted online by visiting [www.eliyet.eu](http://www.eliyet.eu).

## 6.3 Set-up

The Edge Styler has two set-ups:

### 1. Working set-up

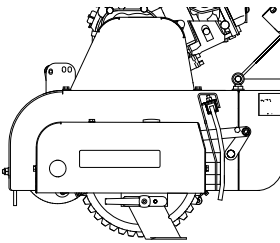

In configuring the styler for operating mode, the blade arm should be tilted to its lowest position and locked in place. The blade driver is active in this mode, in which case the blade slices at a rate of 1,000 jabs per minute. In this mode, there is an increased risk of cutting wounds. Therefore, the operator should always operate the machine from the proper position behind the steering.

### 2. Transport- or storage set-up

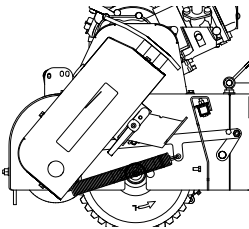

In this mode the blade arm is propped up (quasi vertically) in its highest position. The blade driver is also decoupled, and the blade does not move. This is considered a safety mode for transporting the machine.



**Warning:**

All intermediary positions of the blade arm, meaning when positioned between its two extremes, are considered to be in a transitional state and are, thereby, limited in usefulness when the blade is thrust into the ground. These should not be used whilst operating, transporting, stowing away, or performing maintenance on the machine.

If the motor unexpectedly becomes engaged when the blade is intermediately positioned, then the threat to safety and risk of slicing wounds becomes unequivocally real.

# 7. Safety instructions



## 7.1 Safety messages



### Caution:

Whilst operating or performing maintenance, suitable clothing and protective gear should be worn. Doing so will avoid potential accidents. Working with or performing maintenance on the machine poses the risk of slicing wounds to the hands. Be attentive and cautious.

Safety stickers or relief images have been affixed on to visible areas of the machine. Make a note of the icons and warning messages specified on these stickers..

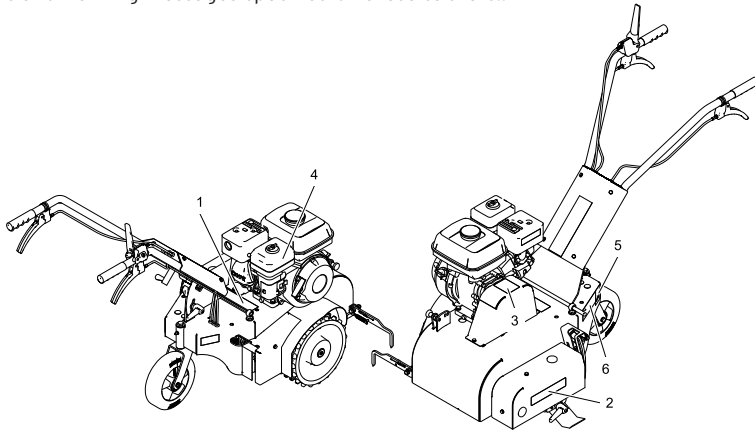

- |  |  |
|--|--|
| 1) Sticker with pictogrammes and general info (BQ 505 010 171) | (BQ 505 010 370)                           |
| 2) Sticker - Danger! Keep hands clear (BQ 505 010 380)         | 4) Sticker - idling speed (BQ 505 010 020) |
| 3) Sticker - Belt shield                                       | 5) Noise level                             |
|  | 6) Identification sticker                  |



### Caution:

Safety stickers or parts that include safety information that are damaged due to use or cleaning, become illegible or have been removed must be immediately replaced. Stickers and parts can be obtained from your official ELIET dealer.

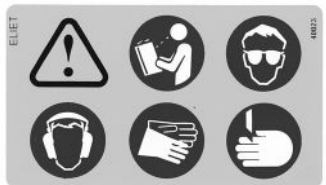

- This sticker provides a summary of the general safety regulations by using icons:
- Before operating the machine the manual should be read and understood.
- Suitable safety clothing (gloves, safety glasses, ear defenders) should be worn when operating the machine.
- Operating or carrying out maintenance on the machine presents the risk of injury to hands. Be alert and careful.



- this sticker reminds the operator to switch off the engine and release the spark plug cap before carrying out maintenance on the machine. This is to prevent the motor from unexpectedly switching on whilst performing maintenance.

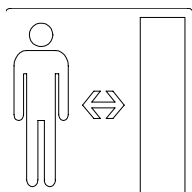

- This sticker reminds the operator to keep bystanders at a safe distance. As a general rule, everyone should remain at a perimeter of at least 3 meters away from the machine. If anyone ever comes within proximity of the machine, the operator should stop the wheel drive, lift up the blade arm, and turn off the motor.

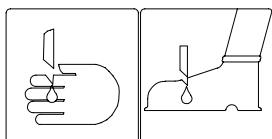

- The pictogram and warning message on this sticker informs the operator and bystanders of the impending danger of being inflicted with cutting wounds in the vicinity of the blade and blade driver. One should keep at an appropriate distance from this zone and be on high alert.



- This sticker points out the danger which can occur if the guard is removed while the motor is rotating. Never operate the machine if the guard is not in place.



- The machine's motor runs at a lower idling speed: 2800 revs/min. This reduces the amount of noise produced by the machine as well as energy wastage.

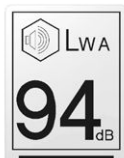

- This sticker shows the sound power level (LwA) expressed in decibels d(B)A, which is a guaranteed minimum that the machine will produce under normal operating circumstances.



This unique sticker contains all of the identifying elements of the machine.

- Year of manufacture
- Model
- Type number
- Serial number
- Capacity
- Weight
- Guaranteed A-weighted noise level

In addition, the sticker bears company information of the manufacturer. The sticker bears the seal of conformity with European standards in the form of a CE label.



#### Caution:

Safety stickers or parts that include safety information that are damaged due to use or cleaning, become illegible or have been removed must be immediately replaced. Stickers and parts can be obtained from your official ELIET dealer.

## 7.2 Safety features

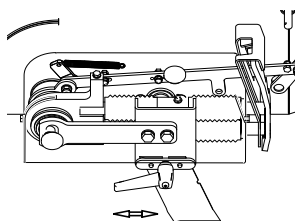

#### Cutting mechanism:

This ELIET machine is uniquely designed to edge lawns without producing dust or loose chippings. The risk of injury or harm to others is thereby kept to a minimum.

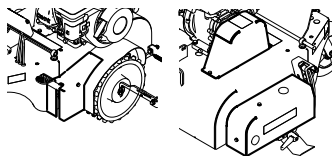

#### Protective coverings:

All outward-rotating parts that could pose any potential danger and lead to accidents are adequately shielded by a protective cover.

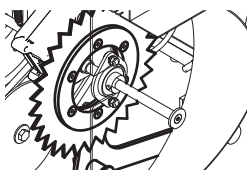
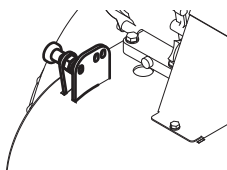
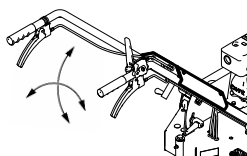
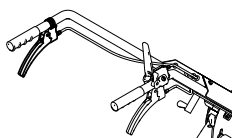
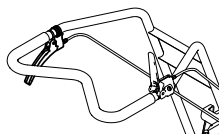
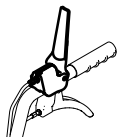
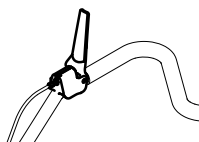

### Dead man's handle:

Mounted onto the steering bracket is a red handle, which serves as a vigilance control for the wheel drive. Releasing the handle will shut off the traction.

### Disconnecting the blade:

Lifting the blade out of its normal operating position will shut off the drive, in which case the blade comes to a stop as soon as it is lifted from the ground.

### Ergonomics:

The styler's steering mechanism is dampened against jarring and is adjustable in terms of steering height and angling. This feature is ideal for the operator in that it allows him to deploy the styler in a way that is best suited for him and the tasks at hand. Not only will he be less prone to injury, he will also not tire as quickly, which is beneficial for safety.

### Anti-deviation disc:

This component ensures that the styler does not deviate off course during operation. The disc minimizes the chance that the styler will slip out of alignment when performing edge work at a sloped angle (for example, styling the edge of a golf-course bunker). Hence, the operator is able to keep the machine better under control in risky situations.

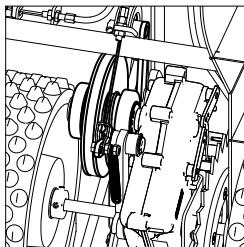

### **Variable driving speed:**

The black lever on the bottom right of the steering bar allows the operator to smoothly regulate the driving speed depending on the type of ground. If the lever is fully released, the machine runs at its lowest speeds. If the lever is fully clenched, however, the styler will run at its highest speeds.

## **7.3 Safety instructions**

---

### **7.3.1 General safety instructions**

- The Owner Manual must stay with the unit during its complete service life. It serves as a reference for the user, and enables the machine to be used and maintained in accordance with the correct instructions. Always refer to this instruction manual if you have any doubts about an action that you are about to perform.
- If the instructions stated in this manual are not clear to you, do not hesitate to contact your Eliet dealer for further explanation. In addition, the ELIET helpdesk is at your service during office hours to answer any queries you may have: (EU +32 56 77 70 88).
- Read the chapter meant for the dealer (see : Chapter 8) and immediately verify whether the machine has been delivered in accordance with the instructions.
- After you purchase the machine, allow the dealer or a professional to give you some instruction regarding the correct use.
- Carefully observe all safety instructions when using the ELIET machine ! Carefully read all the instructions relating to the use of the machine. All these instructions relate to your personal safety.
- Always observe the applicable regulations of the Labour Inspectorate to avoid accidents.
- Read and observe all safety messages posted on the machine in the form of stickers or icons.
- Under no conditions whatsoever may the original design of the machine be modified without written consent of ELIET EUROPE NV (Belgium).

### **7.3.2 Careful and proper use**

- This machine is intended to be used for styling lawn edges or digging narrow trenches for laying shallow, DC- (low voltage) ground cables or irrigation networks just underneath the lawn surface. The machine should only be used for its intended purpose and with original ELIET blades.
- The machine should only be employed on soft ground that is free of foreign objects or other surface obstructions.
- Never use the Edge Styler on frozen land.
- The styler blade makes stabbing motions. ELIET may not be held responsible for damage to the equipment or to personal property as the result of careless or improper use, such as run-

ning the blade over an obstructive object when the machine is engaged.

- It is prohibited to operate the Edge Styler in any position other than the recommended working position.
- It is unsafe for persons suffering heart problems and/or having balance disturbances to operate the machine.
- Think about what you are doing whenever you operate the machine. Do not be tempted to let routine dull your attention. Never act impulsively or in reflex.
- Despite the extensive safety features, do not seek out dangerous situations.
- Never work with a machine that has not been fully assembled. Check the finish of the machine to ensure compliance with the instructions provided in this manual.
- Never attempt to change a machine setting and never perform maintenance when the motor is running.
- The machine may cause an explosion when you work near flammable products, fumes, etc..



**Warning:**

Most accidents are the result of recklessness or incautious behaviour.

### 7.3.3 Responsibilities of the Operator

- All persons using the machine are assumed to be fully conversant with the safety instructions. **The operator is fully liable for the use of the machine in regard to himself and to third parties.**
- It is assumed that the operator of this machine is mature enough and has enough common sense to make decisions by himself.
- Underage persons must not operate the machine. However, this does not apply to youths above the age of 16 years, who are learning to operate the machine under the supervision of an experienced operator.
- A disabled person may only operate the machine when under the supervision of an experienced operator.
- Children (younger than 16 years of age) and animals must be kept well away (> 3 m) from the machine.
- ELIET recommend that the machine should not be lent to others. However, if this is done, only lend it to persons who are conversant with the machine. **Always ensure that the user is aware of the potential hazards, and ensure that he reads the manual before he uses the machine.**
- This machine must only be operated by persons who are in good physical condition. If you become tired during the work, take a rest in due time. Persons consuming alcohol or drugs must not operate this machine.
- The user must draw up a list that registers the number of hours worked. This will ensure that the repetitive maintenance schedule can be followed correctly in relation to the machine.



### 7.3.4 Personal Protective Equipment (PPE)

- You must wear suitable clothing to operate this machine. That is, clothing covering the whole body, heavy protective gloves and closed non-slip footwear.
- Do not wear loose fitting clothing (a shawl, for instance, should be avoided by all means). Long hair should be contained using a cap or a headband, or worn in a ponytail.
- For the protection of the most sensitive senses, Eliet recommends ear defenders and safety goggles.
- You must pay more attention and be more careful when wearing ear protection because noises that announce a danger (such as shouting, signal sounds) will only be heard to a limited degree.
- ELIET do not recommend using a Walkman or a portable MP3 player whilst working.
- Edge styling can produce a considerable amount of dust. ELIET recommends using a dust mask if this agitates your respiratory airways (masks should comply with the 89/686/EEC standard).



#### For your information:

The operator of the machine can reduce the risk of injury by wearing the proper, personal protective gear.

### 7.3.5 Danger zone

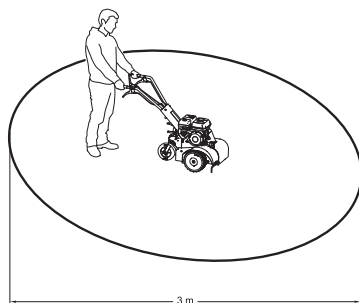

- During the work, do not allow bystanders to enter the risk zone that stretches up to 3 m around the machine.
- The operator should not leave his post unless the blade has been lifted away from the ground and has come to a complete halt.
- Should the machine be defective and the blade does not cease operating upon lifting the blade arm, then the motor should be immediately switched off. The defect should be identified and fixed before commencing operation once again.
- Contact with moving parts may cause injury or damage. Ensure, therefore, that hands, feet or loose clothing are well away from moving parts.
- You must only operate the machine when it is in its normal working condition.
- Do not take any risks and immediately stop the machine as soon as anyone enters the danger area.
- Children and animals must be kept well away from the machine.
- When leaving the machine, the motor must be switched off.

- Once the motor is running, focus all your attention on operating the machine.
- Protective coverings keep danger zones shielded and eliminate the risk of someone involuntarily coming into contact with these areas. Never use the machine if these covers have been dismantled or removed.

### 7.3.6 Periodic maintenance

- Any work done with or performed on the machine that does not involve edge styling or cable trenching, for which the machine was normally intended, is considered to be maintenance. Proper procedures, attire, and conditions for maintenance (see § 7.3.4., § 11: maintenance) should be strictly observed, as prescribed by ELIET.
- Periodic maintenance is essential. For this reason, strictly follow the maintenance schedule in this user manual.
- Given that the blade is a critical component of the styler, its state (that being its sharpness, condition, mounting, etc.) must be inspected on multiple occasions per edging session.
- Sharpen the blades before they become too dull or replace them as necessary (§13 extra equipment).
- The blade should be replaced completely when it has worn down by more than 1/3rd of its original width.
- Draw up a maintenance register in which you keep the performed maintenance updated in detail.
- Regularly cleaning the machine is essential. In particular, keep the air supply for ventilation of the motor free from obstructions. This will prevent overheating and consequential damage to the machine.
- When parts must be renewed as a result of wear or failure, you must always request genuine ELIET service parts from your ELIET dealer. This is important in the interests of your own safety. (Find an official ELIET dealer near you by visiting [www.elieta.eu](http://www.elieta.eu))
- The list of original replacement parts and their ordering code can be consulted online by visiting [www.elieta.eu](http://www.elieta.eu).
- Always ensure the motor is switched off before performing repairs or maintenance.
- Always wear suitable clothing for performing maintenance.

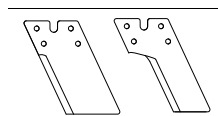

#### **Caution:**

For your own safety, and in the interest of preserving the life of the machine, the Edge Styler should regularly undergo maintenance.

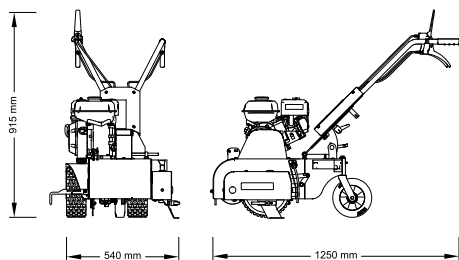

Measurements of the machine (LxBxH in mm)

1250x540x915

Distance from the blade to the outer edge of the left wheel: 10 cm

In the interest of stability and issues concerning the oil quench bath in the motor, the styler should never be employed on a slope exceeding the following parameters:

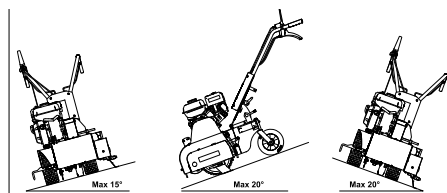

Maximum forward tilt: 20° or 36%

Maximum left tilt: 15° or 26%

Maximum right tilt: 20° or 36%

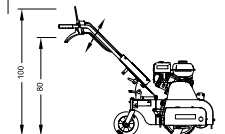

Steering height EDGE STYLER STD:

88 cm

Steering height EDGE STYLER PRO:

max : 100 cm

min : 80 cm

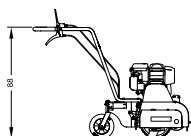

Lateral angling EDGE STYLER PRO:

Lock-tilt left/right at 31.5°

Maximum left/right tilt angle without locking: 50°

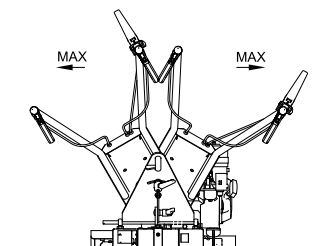

Ground clearance underneath the machine : 4 cm

Maximum elevation of the swivel caster : 15 cm

Span of the tyre tread on the machine :

Inner distance between the two traction tyres : 21 cm

Outer distance between the two traction tyres : 41 cm

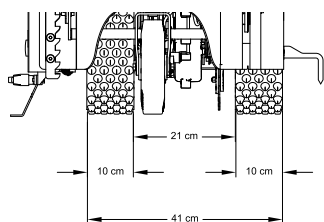

Tyre ground pressure :

STD: traction tyres : 31 kg/wheel; swivel caster : 20 kg

PRO: traction tyres : 35 kg/wheel; swivel caster : 24 kg

Driving speed (motor 2800 T/MIN) :

Edge Styler STD: 0.9 km/h

Edge Styler PRO min. : 0.9 km/h, Max : 2 km/h

Blade depth :

depends on the blade type, min 20 mm, Max 150 mm

Noise level :

sound pressure at the ear of the operator (1,70 m): LwA 83 dB(A)

Sound capacity: LwA : 94 dB(A)

### **7.3.8 In harmony with nature**

- Use the machine in a manner that respects environmental regulations:
- Avoid unnecessary machine running while not at work.
- Avoid spilling petrol while refuelling.
- Never dispose of contaminated motor oil in a drainage well, the toilet, a cesspit, or sewer, etc.
- Oil leaks in the motor or transmission should be immediately repaired.
- Service the engine regularly in order to achieve optimum combustion.
- Any waste materials resulting from performing maintenance on the machine should always be disposed of properly and in their designated place either for recycling or other environment-friendly processing.

## 8. Dealer preparation



**Warning :**

As an ELIET dealer you **must** familiarize your customers with the **functioning of the machine** and also **point out the possible dangers** while using it. You are expected to carefully go over the maintenance points of the machine together with the new owner. Repeat these instructions until the new owner has fully understood everything.



**Warning :**

The manufacturer, ELIET wish to re-emphasise that the Dealer must expressly point out to the customers that they must examine the bolts which retain the chipping blades for security of fixings **within the first 5 operating hours**.

- ELIET machines are packaged in accordance with common rules that apply for such transportation. Deliveries will always be ex factory. ELIET cannot, therefore, be held liable for damages that occur during transportation.
- Should you notice damage to the packaging when goods are accepted, always check the state of the machine to ensure it is not damaged. Report any deviation on the delivery order before signing off for receipt.
- Should the machine be damaged, you should always immediately submit a complaint to the shipping company.

When the machine has been removed from its packaging, it is still not completely assembled. The dealer must finish the assembly. Below we provide a few guidelines :

## 8.1 Parts included

### Edge Styler STD:

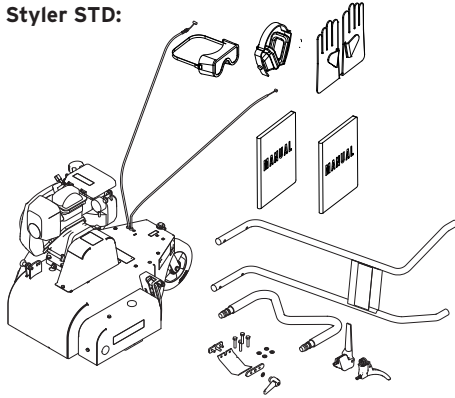

- 1 x machine
- 1 x Set of personal safety gear (hearing protection, protective eyewear, utility gloves, dust mask)
- 1 x Manual machine
- 1 x Manual motor
- 1 x the upper steering
- 1 x the lower steering
- 1 x standard blade
- 1 x dead man's handle

- 1 x black handle (blade arm lock release)
- Plastic bag with:
  - 5 x pinion M8
  - 4 x bolts M8X40 (key size 13)
  - 1 x clamping plate
  - 1 x wing nut M8
  - 1 x positioning plate
  - 1 x cable clamp 8X15 (key size 7)
  - 2 x plastic tensioning strip
  - 2 x screw Ø4 mm

### Edge Styler PRO:

- 1 x machine.
- 1 x Set of personal safety gear (hearing protection, protective eyewear, utility gloves, dust mask)
- 1 x Manual machine
- 1 x Manual motor
- 1 x upper steering
- 1 x standard blade
- Plastic bag with:
  - 4 x pinion M6
  - 4 x bolts M6X10 (Allen key 4)
  - 1 x clamping plate
  - 1 x wing nut M8
  - 1 x positioning plate

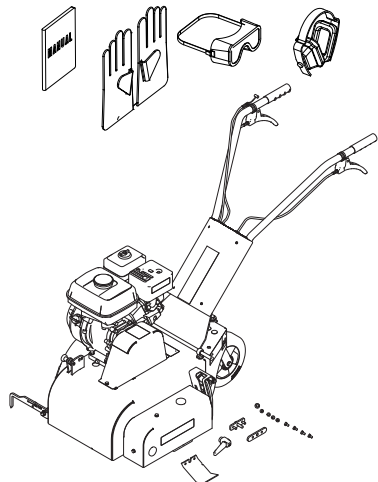

## 8.2 Assembly instructions for the Edge Styler STD

- Place the lower part of the steering rack onto the machine. Screw threads are present in four places on the lowest part of the rack for fastening onto the main body. Use the four M8 X 40 bolts for attaching the pinions (key size 13).
- Whilst tightening the tube, proportionally apply tightening force so as to avoid crushing the tubing of the steering rack.
- Now, slide the red dead man's handle onto the right-side tube-opening of the steering rack.
- Next, slide the black handle onto the left-side tube-opening of the steering rack.
- Adjoin the upper and lower parts of the steering rack by placing the plastic connector joints located on each side of the upper tube into the open ends of the lower one.
- Use a plastic hammer to tap on either side of the upper steering rack such that the two plastic connector joints become completely seated in the lower tube.
- Fasten both sides of the upper tube with a screw so as to affix the upper part of the steering rack onto the connectors.
- Now, add the red dead man's handle, ensuring that it is pointed "upwards" at a distance of 15 mm from where the tubes connect. Rotate it into place until tightly fitted onto the steering rack using the bolt on the right side of the handle (Allen key 5).
- Place the small, barrel-shaped object at the end of the cable (leading from the transmission box) in the opening of the red handle. Now, put the adjustment screw at the end of the cable line through the opening of the lever.
- Feed the lined cable through the opening of the machine and pull it through to the lever that operates the transmission.
- The S-shaped end of the cable is hooked onto the second lever. When pulling on the cable, one lever should tug on the other along the same path.
- Place the cable lining in the opening of the transmission box.

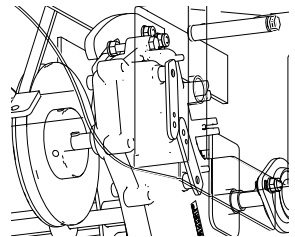
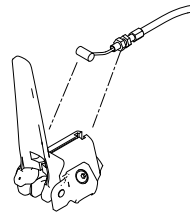
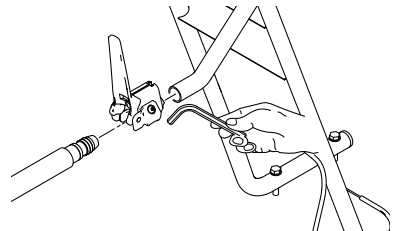
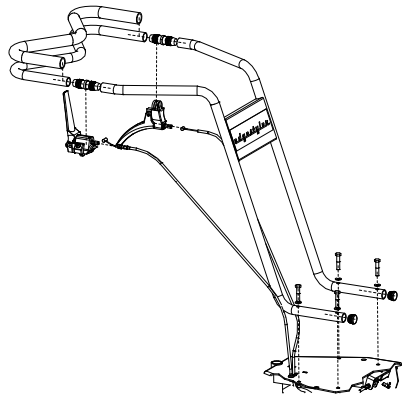

- Adjust the line to get rid of looseness in the cable (read § 11.4.2.8).
- Place the black grip handle downwards and screw it on tightly using a cylinder head bolt, which is accessible on the underside of the handle (Allen key 5).
- Put the cylindrical barrel on the end of the remaining cable through the opening of the handle and feed the cable through the holder. Screw in the adjustment screw of the cable line as far into the lever as it can go.
- Feed the lined cable through the housing of the machine.

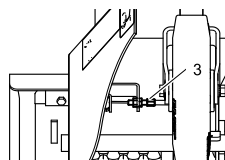
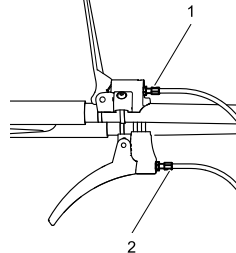
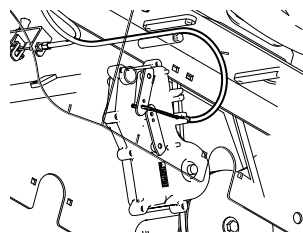

- Now, fasten the cable onto the other end of the latch on the bottom inside of the machine. Guide the cable through the hole in the latch pull handle and slide the included cable clamp onto the cable until completely flush with the latch pull handle. Tighten thoroughly (key size 7).
- Adjust the line here as well to get rid of any looseness in the cable (read § 11.4.2.8).
- Using cable bindings, affix the cable guides to the steering rack such that they are not in the way when operating the machine.
- Assemble the blade (read §11.4.2.5.).

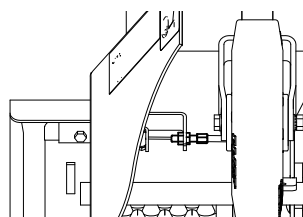
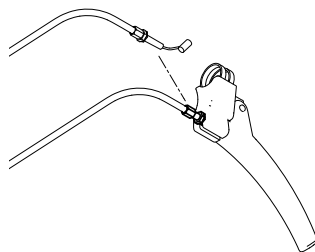



### 8.3 Assembly instructions for the Edge Styler PRO

- There are four rubber vibration dampers visible on the lower part of the steering rack, which has already been assembled onto the machine. The upper part of the steering rack is to be screwed onto the vibration dampers using the four bolts and pinions included
- Before adjoining the upper and lower parts of the steering rack, take care that all cables are properly hooked into place between the two parts, yet are able to move about freely.
- Assemble the blade (read §11.4.2.5.).

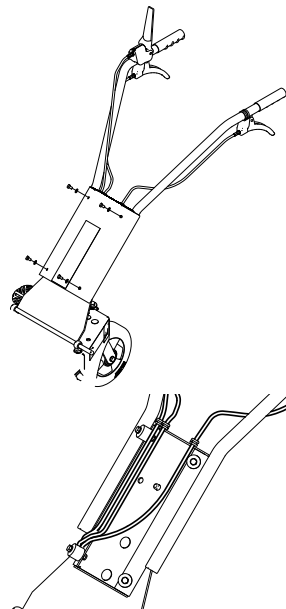

### 8.4 Preparing the machine for use

- Each machine that leaves the factory contains no oil and fuel. The dealer must check the levels of the oil and fuel and top them up in accordance with the instructions in this manual (or in the engine manual).
- Prior to delivery to the customer, the machine should be thoroughly greased and lubricated (read § 11.5).
- Let the motor undergo a quick test run. Adjust the motor's idling speed to a maximum of 2,800 revs/min.
- Subsequently test the operation of the machine:
  - Locking and unlocking the blade arm to/from operating position (cable adjustment).
  - Switching on the blade driver (spring action, belt tension, ratchet on the pedal).
  - Switching on tyre traction (belt tension, cable adjustment).
  - Edge Styler PRO: functioning of the anti-deviation disc.
- Edge Styler PRO: Consult with the customer to pre-set the steering rack to the proper, ergonomic work height (read § 9.4.7: adjusting the steering rack).

Important information for the new owner at the time of delivery:

- Once again, the dealer should clearly define the proper ways in which the machine is to be used.
- The dealer should orient the new owner with how the machine operates.
- The dealer should inform the new owner of all of the potential dangers.

- Read over the enclosed conditions of warranty together with the customer.
- Lastly, make sure that the warranty card is filled in completely and signed. This in order to avoid any warranty disputes. **Red the aforementioned warranty conditions.**

Immediately register the purchase online to ensure your warranty entitlement is activated. (**www.eliet.eu**).

# 9. Operating instructions



## 9.1 Preliminary checks



**Caution:**

Any time any work is done with or to the machine, appropriate clothing should be worn in addition to personal safety gear.

Before commencing the work, it is recommended to get into the habit of checking the following points.:

**Checklist**

1. Perform a visual inspection of the condition of the machine.
2. Check the total number of hours the machine has operated and compare this to the maintenance table.
3. Double check whether the parts are free of deformations, and inspect the weld joints.
4. Check to ensure that the parts are tightly connected and that there is no excessive looseness.
5. Check the oil level of the machine. (see § 11.4.1.3.) and, if necessary, have a read through the maintenance booklet from the manufacturer of the motor.
6. Ensure there is enough petrol in the tank. If necessary, fill up the tank with petrol.
7. Check to ensure that all protective coverings are present and affixed properly.
8. Satisfy yourself that the knife is firmly in place and in good condition. If it needs to be sharpened, this must be done first. If one detects cracks or fractures in the blade, it must be immediately renewed.
9. Ensure that the blade's mounting holes have not become oval in shape and that the screw threads have not been damaged.
10. Check whether all safety provisions on the machine still operate. (see § 7.2 safety features).  
If an abnormality is discovered, always carry out the necessary repairs first, before using the machine.

Once these items have been checked and approved, you can prepare the area of operation (see Chapter 9.2) and move the machine to the work site.

## 9.2 Preparing the work site



*borduur - recht - STD - hoek - u-vormig - golfbunker - draadgraaf*

The Edge Styler can be used for various applications :

- Shaping lawn edges to create a multi-level raised bed.
- Renovating an existing lawn edge.
- Creating an opening in the grass (for laying a flowerbed for example).
- Creating an opening along hardened edges (terrace, porch edge, garden path).
- Digging shallow trenches in a lawn.
- Digging paths for burying underground wiring.
- Cutting high grass.

For each of these applications, a reference path should be plotted out and marked on the grass prior to starting. This can be accomplished using a string and pickets, after which point the path can be used as a reference line for styling the lawn edge.

The Edge Styler is equipped with a guide to the right side of the edge dresser and can be folded down when not in use (Standard with the Edge Styler PRO, optional on the Edge Styler STD (order code : MA 022 001 003)). The guide makes it easier to follow the string for a more exact cut. The tip of the guide is located 600 mm away from the moving blade.

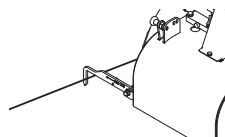

### 9.2.1. Plotting out a reference path

Tips for plotting out a reference path are as follows:

- When edging your lawn, the styler should preferably be operated on surfaces or terrain that is as flat and smooth as possible in order to ensure the utmost precision in the cut. Hence, try to move in a direction that will allow you to always keep on the grass (or otherwise, always keep on a hardened surface).
- Determine where exactly you will begin styling the lawn edge or opening. Using a ruler or stick, mark off an initial reference point approximately 60 cm away from the starting point (with pickets) and tie it off with rope.
- If the path is a straight line, then you will need to mark off a second reference point at the end of this strip.
- If the path runs in a free-form curve, then you should mark off a series of reference points in order to create a polygon that matches the curvature as closely as possible.
- This procedure should be repeated until the entire zone to be styled has been plotted out completely.

## 9.2.2. Achieving quality results by avoiding damage

So as to avoid damaging the machine and to guarantee a quality result in your efforts, it is advised to operate the machine only on amicable terrain.

- Check the pre-plotted reference path for any surface objects or above-ground obstacles that could hinder the styler or prevent the operator from working smoothly. Clear as many of these obstacles away from the work zone as possible.
- Also, inspect the entire path to ensure that there are no underground obstacles or foreign objects that appear in the cutting zone of the blade. This includes all material that is not vegetation, is broader than a span of 3 cm, or has a hardness that is not penetrable at a point load of 5 kg (such as stones, bits of metal, metal wire, glass, plastic, tree roots, foundation, etc.).
- Remove as many of these obstacles from the cutting zone as possible. If such a foreign object is impossible to remove, then flag the spot for future warning, so as to prevent damage to the machine during operation.
- Sufficient checking must occur to verify whether any under- or above-ground electricity cables or irrigation networks cross the styling path.
- It is prohibited to operate the styler on frozen or dried-out land
- It is advisable to style your gardens or lawn edges after a period of rain, after which point the soil will be soft and moist. It should be quick and effortless to shape and style lawn edges under such conditions.
- Styling lawn edges on ground composed of loose sand is not advised for achieving a quality result.

## 9.3 Starting and stopping the engine

### 9.3.1 Starting the engine



#### Caution :

Loudness of the running motor is the predominate source of noise generated by the machine. For this reason, it is suggested that some form of hearing protection be used before starting the motor.



#### Warning :

As soon as the motor begins running, parts of the machine could begin moving. Therefore, it is critical that the operator keep bystanders at a distance and that he focus his undivided attention on the proper operation of the machine.



### For your information:

Carefully read over the starting procedure in advance, which is covered in the motor manual included.

- Before beginning the start procedure, it should first be verified that the blade arm is not positioned in transport mode.
- For proper comprehension of these instructions, we briefly refer you back to chapter 6.2 of this manual where the most critical motor functions are indicated.
- Never start the motor if there is dirt or rubbish between the cooling fin or in the vicinity of the exhaust. This weakens the ability of the motor to properly cool or could cause a fire!
- Before running the motor, check whether it has a sufficient amount of oil ( read §11.4.1.3.).
- Stand to the right side of the steering rack so that the motor's recoil starter is within arm's reach.
- Open the fuel tap (if present) by rotating it to the ON position.
- Switch the general on/off switch to the OFF position (on the Edge Styler PRO, rotate the red rotary knob to the ON position; on the Edge Styler STD, turn the thrust lever out of lower position).
- Set the thrust lever to full throttle (hare symbol).
- Close the throttle (CHOKE CLOSE) during cold starts. This can be achieved (on the STD) by pulling the metal ring towards the outside or (on the PRO) by sliding the choke knob to the left.
- Forcefully tug the recoil starter, using long strides, until the motor starts.
- As soon as the motor starts running, the throttle (CHOKE OPEN) should be reopened.
- If you fail to do this, then the motor will run irregularly, slow down, release heavy smoke, and ultimately shut down completely. If this still occurs, then simply redo the starting procedure without using the throttle (CHOKE). Should the motor no longer start up, however, then this means that the spark plug is drenched in oil and should be cleaned off or replaced.

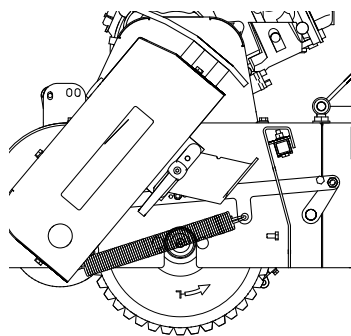



**Warning :**

Under no circumstances should you ever allow the motor to run for an extended period (that is, more 30 seconds) in a closed space. The exhaust fumes contain toxins, which can lead to poisoning or suffocation.

### **9.3.2 Stopping the engine**

To stop the motor, perform the following operations:

- Switch the blade driver off by unlocking the blade arm and positioning it into transport mode.
- Set the thrust lever in neutral, and let go of the red handle.
- Switch off the motor (on the EDGE STYLER PRO, turn the red rotary knob to OFF position; on the EDGE STYLER STD push the thrust lever just past neutral).
- If present, shut the fuel tap.

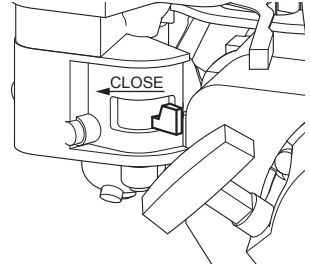

## **9.4 Operating the machine**

### **9.4.1 Principles of operation**

In order to operate the machine properly, be on top of every situation that could possibly present itself during operation, and approach these situations in a well-thought-out manner, several principles of operation for the machine have been established, which are briefly explained below:

Secondary to each application of the machine, it ends up being the case that a particular type of cut into the soil must be achieved. The method for achieving this is simple: a horizontally moving blade that rapidly moves back and forth is driven through the ground by way of the wheel drive. The groove is created, on the one hand, by short bursts in the jabbing motion of the blade and, on the other hand, through the pressure of the wheel drive.

In the interest of having this run optimally, a number of factors play a critical role:

- Blade selection (type and depth)
- Blade sharpness
- Tyre grip and driving speed
- Compactness of the soil

We briefly explain below what the importance is of these elements and describe the type of impact that they might have on your work:

**Blade selection :**

ELIET offers a wide selection of various blade types. The shape of each type is specifically designed for a specific application. In order to achieve a quality result as well as be able to comfortably operate the machine, a blade should be selected corresponding to the task at hand (see Chapter 13: overview of blades & applications).

Apart from the blade type selection, the length of the blade is also important. The length of the blade determines the depth of the cut. The deeper the cut, the tougher the ground resistance, in which case the extended length increases the likelihood that the blade might hit an obstacle within its reach. Always strive to use the shortest possible blade.

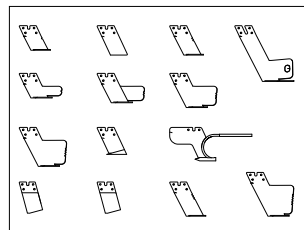
**Blade sharpness :**

Each blade slopes in the front, down to a sharp edge. Even here, the width of the cut determines the resistance when breaking ground. The duller the cut, the less far the blade cuts into the ground with each jab. This results in a recoil effect, which is experienced by the operator as a jarring or jolting sensation at the steering rack. Regular maintenance of the blade edge is essential.

**Tyre grip :**

Considering the wheel drive is the key component ensuring that the cut is properly made at full length, the grip of the tyres is essential to the efficiency of the machine (expressed in m/hour). If the tyres begin to slip, then the machine will not move forward. ELIET designed the tyre tread with studs so as to provide optimal traction and minimal slipping. It is important that the force of the tyre grip on the ground is greater than the resistance that must be overcome in order for the blade to cut through the soil. As the tyre tread becomes caked in with soil, the effect of the grip wears off; thus, it is necessary to regularly clean off the tyres.

Rain softens the ground, which in turn reduces the amount of cutting resistance on the blade. Nonetheless, employing the machine on softer ground makes it more prone for the tyres to become caked in and lose grip. Therefore, it is highly recommended to wait until the grass has become dry. If there is adequate grip, yet the driving speed does not coincide with the resistance on the blade, then this could also cause a problem. Given that the blade moves on the left side of the machine, the resistance upon it is effectively the same as a brake on the left wheel. This triggers a differential balancing mechanism, which

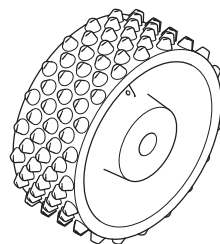

clean wheel



transfers excess traction over to the right wheel, preventing the machine from dragging to the left.

### Compactness of the soil:

Every type of soil exhibits its own properties. These properties have critical influence on the speed and ease at which the blade is able to chop its way through the soil. Extreme soil compositions carry with them a number of inconveniences that negatively influence the operation of the machine :

- Soil that is too thick (clay, for example) is composed of tiny bits of particles, making it extremely homogeneous. Theoretically speaking, this type of soil would appear to be easy for the blade to penetrate; however, due to the fact that it forms a dense and solid mass, it clumps onto the blade causing it to move very slowly (with greater inertia). This introduces extra jarring and forces the operator to move slower.
- Soil that is too loose (sand, for example), cuts very easily given its loose composition; however, this does not always produce the finest result (in terms of smoothness and sharpness). Sodded lawn is also not entirely optimal.
- Stones lodged into the ground will not be cut by the jabbing of the blade. Thus, if a stone is ever in the blade's path, it has to force the stone out of the way in order to proceed further. Tiny rubble ( $\emptyset < 20$  mm) is easily cast aside and does not really interrupt operation. Large stones are a bit more imposing, creating hindrances that would be far too great a challenge for the machine. In such cases the machine might become thrown heavily out of alignment as it attempts to detour its way around the object. This makes it impossible to make a straight cut.

If there are too many such stones in the ground, then the machine cannot be used, unless these objects have been removed.

Whilst working, always be mindful of these key factors, so as to properly be able to comprehend the behaviour and functioning of the machine.

## 9.4.2 Thrusting the blade into the ground

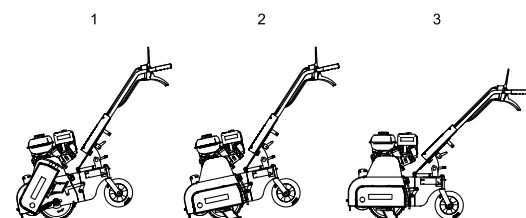

Once the motor has begun running, it can be seated into the ground. If the motor is not running, then there is the possibility that you will deform or break the foot pedal.

- Be sure to check that the motor is running.
- Tilt the machine forward over the traction tyres so that the body supports itself against the ground and so that the tyres can be lifted.
- Hold the machine in this position and use your right foot to press down on the pedal. The blade arm will drop down and the pinion will lock into a certain position.
- The pedal comes with a ratcheting mechanism, so that the step-like motion can repeat until

the blade arm is completely locked into its horizontal position.

- Now, tilt the machine back again over its tyres until supported by the swivel caster on the ground. This tilting motion drives the horizontally oscillating blade into the ground.



**Caution :**

It serves no purpose to exert full force or attempt to support one's full body weight on the foot pedal. This can only result in breakage or damage to the pedal.



**For your information :**

To make it easier for the blade to initially penetrate the ground, it is suggested to use a spade to dig a vertical opening in the spot where you will begin working.

### 9.4.3. Working with the machine



**Caution :**

The operator should wear personal safety gear any time the motor is running. This includes safety boots or protective footwear, utility gloves, protective eyewear, and hearing protection.

After performing the necessary checks (§ 9.1), preparing the working terrain (§ 9.2), and getting the motor running, the work may commence. As the operator, always follow the prescribed safety recommendations.

- Whilst working, the operator shall always operate the machine from the operating post, meaning from behind the steering with both hands on the grips. This is a safe position that is out of harm's way (read §7.3.5).
- Set the machine at the starting point of the path that was plotted out, so that the guide arrow points just above the reference string (the guide is optional on the Edge Styler STD).
- To keep the machine from deviating off course whilst edging up a lawn, it is equipped with an anti-deviation disc (only for the EDGE STYLER PRO; optional on the Edge Styler STD). Activate the anti-deviation disc (§ 9.4.5.).
- The blade driver is automatically activated when switching the blade from transport mode into operating mode.
- The operator can position the blade arm in operating mode using a foot pedal on the right hand side of the machine.
- Once the blade is in the ground, the wheel drive can be activated. For this, press down on the red handle on the right side of the steering.
- This is how you drive the machine along its path.

**Warning :**

Under no circumstances should the dead man's handle be blocked or tied down with anything such as rope, tape, etc. Were this to be done, then the machine would not readily come to a stop in an emergency situation.

- The driving speed should be adjusted as appropriate, given the working conditions (for example, the structure of the soil, its hardness, the type of blade, etc).
- If the state of the ground is such that the resistance on the blade is too substantial for standard driving speed, then the dead man's handle should be pressed up and down in an alternating fashion so as to slow down the driving speed.
- On the Edge Styler PRO, there is a second handle underneath the dead man's handle (a traction lever). This second handle is used for controlling the variable speed. Clenching on this handle can boost driving speeds by 30.
- As you proceed down the work path, it will become apparent that the machine has a tendency to pull to the left. This phenomenon is attributed to the fact that the blade is mounted onto the left side of the machine and, thus, behaves as though it were a brake for the left tyre. The degree to which this phenomenon is exhibited will fluctuate, depending on how much the ground resists against the blade. In order to compensate for this, you will constantly need to steer the machine to the left.
- This effect can be considerably neutralised by adding on a tail weight. A tail weight is an extra weight applied at the same height as the swivel caster. ELIET optionally provides a weight carrier, which can hold a maximum of two 20 kg weights (order number : weight carrier MA 022 001 005 and tail weight (20 kg disc) MA 601 002 000).
- If the machine begins exhibiting heavy jerking, this is an indication that the blade is colliding up against a rather fierce obstruction. It is useless to push against the machine with additional force, as this can only result in more damage to the blade or to the blade carriage. Switch off the wheel drive immediately (release grip on the red dead man's handle).
  - In this situation, the operator is faced with two options :
    - He can lift up the steering so that the machine tilts over on its front wheels and the blade lifts out of the ground. Then, the machine can be pushed forward by 20 cm or so, so as to surpass the obstacle. The machine would then be tilted back in order to reseat the blade into the ground.
    - The second option would be to lift up the blade arm. The blade arm would then need to be disengaged from operating mode by clenching on the handle on the left hand side of the steering. From the force of the spring, the blade arm will be jacked into transport mode. If the blade arm remains stuck in the ground, the steering should be lifted up so as to clear the blade from the ground. Next, push the machine forward past the obstacle, and reseat the blade into the ground using the procedure described above.
- Whilst working, if you notice any strange noises, then cease operation immediately.
- Stop the motor (also see §9.3.2 on stopping the motor), wait until it comes to a complete stop, then investigate what might be wrong with the machine.
- If repairs are necessary, remedy the culprit first, prior to continuing operation.
- The Edge Styler PRO has a bonus feature allowing the steering to be set at an angle. Depending on the working conditions (hillside slopes, overgrown bushes, etc.), it can be important for

the operator's own personal comfort and safety to be able to adjust the steering at an angle (read § 9.4.7.).

- Gardening tools that can be extremely useful in styling lawn edges are : a wheelbarrow for casting off sod, a shovel for digging up sod, a spade for prepping areas where the edge styler might have trouble getting past.
- If the Edge Styler is being used for laying cable or cutting overgrown grass, install a blade that is suitable for this task (read chapter 13 and § 11.4.2.5 : blade installation).

#### **9.4.4. Checking oil and petrol levels**

Upon starting the machine, it is best that the oil and petrol levels are at their maximum. This allows you to work over longer periods without interruption, and you avoid a few other problems as well.

When filling her up, it is recommended to use fresh, unleaded petrol, preferably with an octane index of 98 or 99 (read 11.4.1.1. adding petrol).

#### **9.4.5. Activating the Anti-deviation disc**

Particularly when styling free-form lawn edges, the pressure on the wing of the STD blade causes a large amount of force to be exerted on both the blade and the machine, causing it to drift. You can compensate for this by using the anti-deviation disc.

- On the front side of the machine, to the right, you will notice a holder with three positions. On the left side of the holder is a lever with a locking pin.
- This lever is connected to a toothed disc, which we call the anti-deviation disc.
- By moving this lever towards the direction of the motor, the toothed disc is rotated downwards so that the teeth of the disc protrude lower than the tread of the right tyre and penetrate into the ground due to the weight of the machine.
- As the machine moves forward, the toothed disc rotates in parallel, anchoring its teeth into the ground. This effectively prevents the machine from deviating sideways in either direction.
- To avoid losing grip at the right-side tyre, as a result of using the anti-deviation disc, the disc can be set at two different depths. The depth can be adjusted based on the hardness of the ground underneath the machine.
- The anti-deviation disc should be used on the ground to be landscaped. If used on a surface or ground that is not properly suited for use with the Edge Styler, then the surface itself can become damaged.

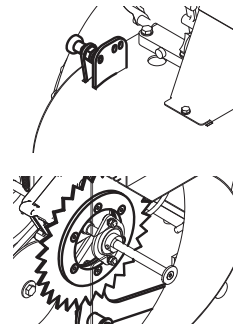

### **9.4.6. Adding extra tail weight (only on the PRO)**

Adding extra weight to the machine can increase its overall inertia. This has two important advantages :

- Whilst the blade is engaged, counteracting forces are exerted against it as it penetrates the ground. The motion of the blade is such that it follows the path of least resistance. If the ground force exerted against the blade exceeds the resistance needed to propel the mass of the machine forward, then the machine itself will move, rather than the blade that should be cutting through the ground. This causes a rather annoying, jarring effect on the machine and at the steering rack, which makes work less comfortable for the operator. Increasing the mass of the machine, however, can eliminate this effect.
- Adding weight to the machine increases the pressure on the tyres, which thereby increases their traction. The braking effect caused by the blade near the left tyre, thus, is minimized. At the same time, by putting on weight to the back side, this creates a counterbalancing effect that works against the tendency for the machine to rotate left. This completely rids the operator of the need to exert extra effort to correct this tendency whilst steering.

The extra weight should be ordered from an ELIET-authorized dealer, (order number: weight carrier MA xxx and tail weight (20 kg disc) MA xxx). The installation should be completed as follows:

- The weight carrier is a metal plate that gets screwed on together with the steering holder.
- Loosen the nut for adjusting the height of the steering rack completely, and remove the bolt (M8 x 30).
- Place the weight carrier with locking tab on the left hand side of the steering holder.
- Plug the M8 x 40 bolt that was included into the hole of the lower part of the steering rack, steering holder, and weight carrier before tightening the nut again.
- Now, to the left and right of the back side of the machine, a 20 kg weight can be hooked onto the weight carrier.

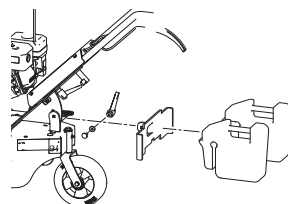

### **9.4.7. Adjusting the steering (Edge Styler PRO)**

The steering on the Edge Styler Pro can be adjusted for both height and angle. Adjust the Edge Styler Pro's steering properly so that you do not experience back problems after extended periods of work using this machine.

When working on a slanted area, the steering on the Edge Styler PRO can also be tilted to the side for optimal control and ergonomic positioning.

- The height can be seamlessly adjusted by loosening the handle underneath the steering of the Edge Styler PRO, selecting the proper height in tilting the steering, then tightening the handle once again. It is important that the steering again be made sturdy. This guarantees optimal control during operation.
- Setting the steering at an angle can also be done seamlessly.

- There is a 100° range of motion in the steering angle, 50° in each direction from the normal.
- To adjust, first loosen the middle lever underneath the steering.
- The entire steering is decoupled by rotating the locking pin, the uppermost lever, downwards.
- Move the steering rack laterally to the preferred position or in 1 of the 3 pre-sets (upright, 31.5° left offset, 31.5° right offset).
- Should you decide to use one of the pre-sets, then you should first set the locking pin in an upright position.
- If a random position is chosen, then you only need to screw the middle lever back in.
- The middle lever should also be screwed in when operating the machine at one of the pre-set angles.

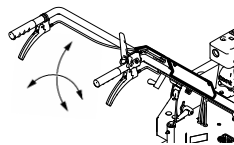

#### For your information :

The fixed positions in which the locking pin is switched are much more stable and cannot shift during operation of the machine.

## 9.5 Troubleshooting

Any efforts to troubleshoot defects or malfunctions are considered forms of maintenance. Be mindful, as well, of the specific safety recommendations for maintenance (read § 11.1).

### 9.5.1. Motor fails to start after idle periods

If the machine fails to start up after periods of inactivity, then this could be the result of any of the following causes:

- Low on petrol
- Petrol is stale
- Bad spark plug

Take the following steps to restart the machine in case of one of the following:

#### **Low on petrol:**

- Usually when stowing away the machine for a long time, it is advised to empty out residual petrol. It is possible for this to slip your mind, in which case you forget to refill the machine.
- Therefore, verify that there is adequate petrol in the tank, and fill her up as needed (read § 11.4.1.1.).
- Close the throttle (choke) so that the petrol is sucked into the line.
- Tug forcefully on the recoil starter cable several times until the motor starts running (see : §9.3.1: starting the motor).

- The motor will start running when the carburettor has filled again.

### **Petrol is stale:**

- Petrol has a limited shelf life. If the fuel has been sitting in a petrol tank for more than a few months, then this can cause problems starting up the motor. Stale petrol can be spotted by its abnormal odour.
- Pump out the contents of the petrol tank, in this case, until it is empty.
- Refill the tank with fresh petrol (read § 11.4.1.1.).
- Give the start procedure a go once again



### **Caution :**

Always exercise precaution. Even stale petrol can still be incredibly flammable.

### **Bad spark plug:**

- Without the proper ignition, it will be impossible to get the motor up and running. For this reason, check the spark plug (see §11.4.1.5.: Checking the spark plug).
- Should you have any doubts or concerns, consult your ELIET dealer, who most certainly will be able to assist you further.

Replacement parts can always be obtained at any ELIET-authorized dealer. Authorized dealers may be found at [www.elieta.eu](http://www.elieta.eu).

## **9.5.2. Motor shuts off whilst in use**

If the motor suddenly shuts off during operation, this could be the result of a number of factors:

- Ignition problems
- Low on petrol



### **For your information :**

Before diving into any inspection, check whether the general On-Off knob has not accidentally rotated to the Off-position

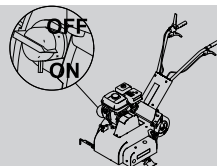

Take the following steps to restart the machine in case of one of the following:

### **Problem with the ignition**

- The ignition is crucial for proper functioning of the motor. If the motor suddenly ceases to operate without cause, this could indicate a defect in the ignition. For this reason, check the spark plug. Read on about this in § 11.4.1.5.

- If the problem is identified here, then the spark plug should be replaced or the electrical workings of the motor should be inspected. Consult your authorised ELIET dealer for more information.

### **Low on petrol**

- Might you become so absorbed in your work that you fail to realise from the indicator arrow that the machine is running on empty, then it could suddenly turn off. If this occurs, simply fill her back up with petrol (read §9.4.3).

If either of the aforementioned inspections do not identify the culprit, then the problem could be more technical in nature. A defect in the motor or problem with the carburettor could be the issue. It is advised in this instance to consult your authorised ELIET dealer.

## **9.5.3. Problem with the blade driver**

Pushing down the blade arm should automatically activate the blade driver. If this does not occur, then the following causes should be considered :

- Insufficient belt tension
- Breakage of the extension spring
- Defective bearing on the eccentric transmission

Take the following steps to restart the machine in case of one of the following:

### **Improper belt tension**

- The belt is kept tense by way of a small belt tensioner, which pulls against it.
- When the belt has been stretched too much after several hours of operation, this could result in the belt tensioner being less effective.
- Switch off the motor and pull the spark plug loose.
- Disassemble the belt cover attached to the motor (read § 11.4.2.1.) and check whether the belt has the proper amount of tension when the blade arm is positioned in work mode.
- Tighten the belt as needed (read § 11.4.2.3.).

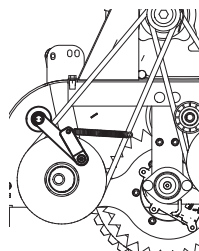

### **Breakage of the extension spring.**

- As the blade arm descends, the belt tensioner pulls against the drive belt by way of a spring. If this spring breaks or comes loose, then the belt tensioner will no longer be active and will not produce the necessary driving force.
- Take off the protective covering from the blade carriage (read § 11.4.2.1.).
- Check whether the spring is still intact.
- If need be, reattach the spring or replace it with a new one.

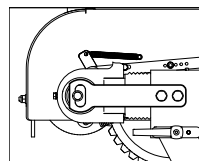



**Broken bearing on the eccentric transmission**

- The piston rod that moves the blade carriage back and forth is driven by an eccentric. The connection between the two is a small, needle roller bearing.
- If this bearing has broken apart or come loose, then the piston rod would no longer be connected to the drive axle, meaning the blade carriage would no longer be properly powered.
- Take off the cover of the blade carriage (read § 11.4.2.1.).
- Check whether the bearing is still intact.
- Perform the repairs or install replacements as needed.

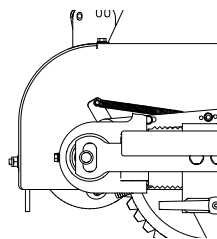

Replacement parts can always be obtained at any ELIET-authorized dealer. Authorised dealers may be found at: [www.elieta.eu](http://www.elieta.eu)

## 10. Transporting the machine



The machine is equipped with wheel drive, which can be used for transporting the machine to the work zone or for loading the machine.

Even without the wheel drive, the machine should be smoothly transportable, given that its wheels are equipped with roller bearings.



### Caution :

A machine with running motor poses more of a risk than one with the motor switched off. Ground-type permitting, and pending sound ergonomics, ELIET recommends pushing the machine during transport.



### Warning :

Even though the machine seems small, do not underestimate its weight. The machine weights approximately 90 kg. Never try to lift and carry the machine alone. This can create severe back problems.

- It is preferred that the blade be disassembled (read § 11.4.2.5.). Doing so prevents the protruding blade from causing injury or damage.
- Only adults are permitted to move or transport the machine.
- Choose a clear and free transport path, preferably one with as few obstructions as possible. It is highly recommended that the machine be transported on flat, solid ground.
- During transport, no children, unauthorised persons, or animals should be anywhere within a 3m radius of the machine (see § 7.3.5.: Danger zone).
- Never use the machine for transporting people or objects.
- If you would like to use the traction for transporting the machine between two different work zones, then you should check to ensure that the blade arm has been positioned into transport mode and that the blade has been disengaged.
- Never drive or place the machine on any floor or land surface that cannot support the weight of the machine (> 90kg) plus one's own body weight.
- If you need to go over a dropped kerb, never permit the machine to traverse the edge freely and uncontrolled. This can deform the wheel-base or cause damage.

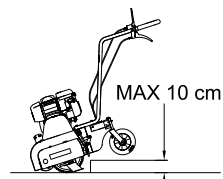

- When driving the machine over a kerb or any descending or raised edge more than 10 cm high, an intermediary step should be improvised by placing an object, preferably a rectangular bar, in front of the edge. The object should be equal to half the rise height.
- The edge should be ascended going backwards, in which case the swivel caster should always be tilted from the ground.
- Descents should always be approached going forwards. This gives you better control over the machine, and it eliminates the possibility that the blade carriage's drive belt will bump against the ground.
- Carefully choose a clear and free transport path, preferably one with as few obstructions as possible.
- The transport path should preferably be flat, with an even bottom.
- When moving in reverse with the machine, first always check to ensure that there are no obstacles that could cause an accident
- When loading the machine into a lorry or utility trailer, always use wide loading ramps with plenty of friction. Ensure that the loading ramps are able to support the weight of both the machine and the operator.
- Considering that the machine is supported on three wheels, planks of 250 mm each should be used so that all three wheels can be supported when the planks are shoved together.
- Take care that the loading ramp is firmly connected to the vehicle or the utility trailer.
- If loading the machine onto a utility trailer, then the trailer itself should be hitched onto a vehicle.
- Make sure that the vehicle's parking brake is on when loading and unloading the machine.
- Ensure that there is adequate space at the end of the loading ramp (4 m).
- Under no circumstances should the upwards slope exceed 15°.



**Caution :**

Consciously handle the machine with care whilst loading and unloading so that it does not tip over and lead to an accident.

- The machine weighs 90kg. Never attempt to lift and carry the machine without the assistance of someone else (maximum load per person should be no more than 30% of any one person's individual body weight). Always request sufficient help from other persons.
- When lifting, grab the machine as closely to the body as possible and support the lift with the leg muscles (drop the knees and lift with a straight back).



**Warning :**

Never overestimate your own strength. Even lifting and carrying an overly strenuous load for a few centimetres and releasing it quickly can cause severe back pain.

- Always properly secure the machine from moving before taking off. If the weight of the machine starts to shift in the vehicle, then this can lead to severe damage.

# 11. Maintenance



## 11.1 General

ELIET recommends that the machine should be brought to an official ELIET dealer for a major overhaul each year. (Find an authorized ELIET dealer near you by visiting [www.elieta.eu](http://www.elieta.eu)) Your ELIET dealer is always at your service for maintenance and advice. Your dealer will stock genuine ELIET service parts and lubricants. Your dealer's staff can always obtain advice and service from ELIET's helpdes so that they can provide you with an impeccable after-sales service.



### Caution :

Only use genuine ELIET replacement parts. These service parts are manufactured to the same strict quality control requirements and degree of craftsmanship as the original equipment. The list of original replacement parts and their ordering code can be consulted online by visiting [www.elieta.eu](http://www.elieta.eu).

Perform maintenance in a room intended for this purpose. This room must be:

- Spacious
- Dust-free
- Easy to access
- Clean and tidy
- Well lit
- Quiet

These characteristics are important to enable maintenance to be performed in an optimal manner.



### Warning :

Maintenance performed in an incorrect manner can subsequently compromise the safety of the operator. Damage or consequential damage that arises from a lack of or from faulty maintenance will mean that the warranty shall no longer apply. Therefore, have maintenance performed by engineers with experience and who know what they are doing.

**Caution :**

Always ensure that the motor is switched off before performing maintenance work.

**Caution :**

When performing maintenance, always wear gloves, and also safety glasses for some operations. These are supplied as standard with the machine.

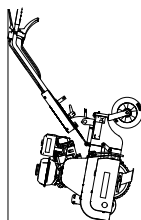
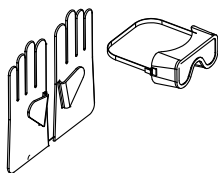

When performing an inspection or doing maintenance, the machine should only be tilted forwards (also see §11.4.2.2.).

## 11.2 Maintenance schedules

---

### 11.2.1 Special maintenance

During the break-in period, some of the machines parts have to settle in. In the first 10 hours, the drive belts will become rather accustomed to a certain, constant amount of stretching. Hence, after the first 10 hours of use, the belts should be tightened again (§11.4.2.3).

The motor oil should be replaced as well after the first 5 hours of use.

**Caution :**

Neglecting this special form of maintenance can render the manufacturing warranty null and void.

### 11.2.2. Periodic maintenance schedule

**Caution :**

Maintenance should be always performed with the motor switched off. As a precaution, the spark plug should also be removed.

**Caution :**

When performing maintenance, adhere to the recommended safety measures.  
Wear the appropriate protective clothing and personal safety gear.

The Edge Styler STD/PRO is susceptible to gathering dirt and rubbish. This increases the amount of wear and tear. A proper maintenance schedule keeps wear and tear on the parts reduced to a minimum and ensures safer operation.

**Daily maintenance**

- Clean the machine. (§ 11.3)
- Follow the checklist (read § 9.1).
- Inspect the blade and the blade mount (§11.4.2.6).
- Check the machine for excessive looseness (§11.4.2.4).
- Check the machine for signs of abnormal wear or fractures.
- Adjust the cables on the operating handles (§11.4.2.8).

**Maintenance after 10 hours**

- Daily maintenance.
- Check the motor oil (§ 11.4.1.4).
- Clean the air filter (§11.4.1.2).

**Maintenance after 20 hours**

- Perform the “Maintenance after 10 hours” if relevant.
- Change the motor oil (§11.4.1.4).
- Lubricate (§ 11.5).

**Maintenance after 60 hours**

- Perform the “Maintenance after 20 hours” if relevant.
- Replace the air filter (§11.4.1.2).
- Replace the spark plugs (11.4.1.5.).
- Replace the belts (ELIET DEALER).
- Replace the bearing on the eccentric (ELIET DEALER).
- Replace the set plate of the blade (11.4.2.5.).

**Maintenance after 100 hours/1 year**

- Bring in the Edge Styler STD/PRO for general servicing.

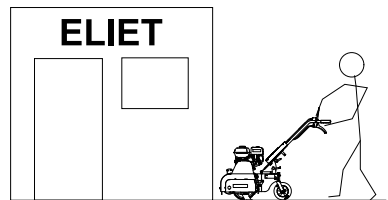
**For your information :**

STD /PRO Running-in oil

After either the first month or the first 5 hours of operation, the motor oil should be replaced. After that, replace the oil after 20 more hours of operation.

### 11.3.1 The importance of cleaning

ELIET recommends cleaning the machine after each use. We recommend using every cleaning event to perform an inspection where you check component and machine integrity. You can, thus, intervene on time to prevent faults and failures. This will ensure that the service life of your machine is improved.

Not cleaning the machine will lead to:

- Increased wear rate.
- Increased risk of fire.
- Reduced motor cooling.
- Reduced performance.
- Safety stickers becoming illegible.
- Not noticing breaks or wear at an early stage.

**NOTE:** You will no longer be entitled to any warranty should you fail to perform proper care and maintenance on a daily basis.



#### **Warning :**

If the machine does not operate optimally, this can compromise the safety of the user.



#### **Caution :**

Any time any work is done with or to the machine, appropriate clothing should be worn in addition to personal safety gear. Utility gloves are necessary.

### 11.3.2 What does cleaning mean ?

Check the whole of the machine when cleaning and subject it to an inspection if required. Check that the parts are not deformed, welded seams are not cracked, and that parts do not exhibit excess play.

Important items:

- The blade mount
- Condition of the nylon bearing
- Dust seal bellows on the blade guide

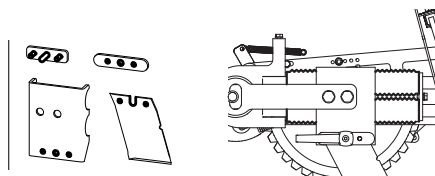

If any problems are found, first conduct the necessary replacements and/or repairs. For this, follow the procedures described in this manual or visit your nearest authorised ELIET dealer. (find an authorized ELIET dealer near you by visiting [www.eli.eu](http://www.eli.eu))

Cleaning the machine means more than just cleaning the outside. Open all protections so that you can also clean the concealed areas.

Special attention must be paid to the following items:

- The cooling air intake of the motor must be spotless at all times. Ensure that none of the air intakes are obstructed. Vacuum clean particles, if required, that can be found behind the intakes.
- The blade carriage guide and its driving components.
- Dirt accumulation around the parts of the wheel drive.
- Dirt accumulation on the foot pedal's ratcheting mechanism.
- Gunk around the inside and outside of the petrol cap. Doing this prevents rubbish from contaminating the petrol and ending up inside the motor.
- Rubbish on the air filter (read § 11.4.1.2.).
- Using a dry cloth, remove any dirt from the frame. Pay special attention to places where stickers with safety messages are displayed. (Do not use any cleaning products that affect paint or stickers.)
- Compressed air is a handy tool to easily blow out and, thus, clean a number of parts.



**Caution :**

Allow the machine time to cool off after operation and before attempting to clean it. Doing so will prevent burn injuries (from the exhaust or motor).



**Caution :**

Water is one of the primary causes of rusting. It is recommended to use a dry cleaning method. Otherwise, dry off the machine and treat it with lubricant.

- Clean off the machine, preferably using a dry utility cloth or soft brush.
- Compressed air may also be used for cleaning off the machines. Never use compressed air at close range of dust-tight bearings and other cap seals, etc. since the air stream can perforate the seals.
- The machine may also be cleaned using a high pressured jet (water), in which case the utmost care should also be taken not to dispense the water within close range of the bearings, seals, protective coverings, and filler caps.
- When cleaning off the housing of the machine, special attention should be given to the areas where safety warning stickers appear.
- If cleaning products are used, they shall in no way damage or corrode the warning message on the stickers.
- Old and dirtied grease and lubricant on the drive components or hinges should be cleared off and the parts freshly re-lubed (read § 11.5).



**Warning:**

Stickers used to indicate safety messages that are no longer legible, must be immediately replaced. Obtain these original stickers from your ELIET dealer. (Part numbers can be found in section § 7.1)

**Caution :**

Protective covers are on the machine so as to shield you from underlying danger. If a cover was removed for cleaning purposes, then it should be placed back into its original position after the cleaning session.

## 11.4 Maintenance procedures

### 11.4.1 Motor maintenance

**For your information :**

All maintenance to the motor is described in the motor manual included.

#### Adding petrol

When petrol in the machine is running low, the fuel supply should be replenished. Always use fresh, unleaded petrol, preferably with an octane index of 98 or 99.

**Warning :**

Petrol, under certain conditions, is extremely flammable and highly explosive. Fire breakouts and petrol explosion can inflict severe burn wounds and cause damage to personal property.

To avoid fire or explosions, be mindful of the following points :

- Never add petrol while the motor is running. Always allow the motor to cool off for several minutes prior to fuelling.
- Only use fresh petrol. ELIET is environmentally conscious and, therefore, recommends using unleaded petrol. To preserve fuel freshness for longer periods of time, additives may be used.
- Store the petrol in an approved tank. Keep out of reach of children.
- Never refuel at the location where the machine is later to be operated. Keep at a minimum distance of at least 10 m from the selected work area. Doing so will avoid creating a fire hazard.
- The petrol tank is situated above the motor (see §6.2 or the maintenance booklet from the motor manufacturer).
- If a fuel tap is present on the motor, rotate it shut prior to filling up the tank.

- Clean off the area around the cap of the fuel tank and remove it.
- Take note that a fuel filter can be inserted into the opening of the tank. Refrain from pouring too quickly, so that the petrol has sufficient time to penetrate the filter without overflowing.
- If there is no tank sieve present, then select a hopper with a filter that can be used to keep unwanted rubbish from getting into the tank.
- Do not fill the tank completely.

STD: only the rectangular tank, not the cylinder-shaped tube.

PRO: just up to the metal ring, which is visible at the opening of the tank. .

- Considering petrol's flammability, keep in mind that the hot exhaust is right next to the tank.
- Put the cap back on the fuel tank as quickly as possible. If any petrol is spilled whilst refilling, then the motor should be immediately cleaned.
- Also be aware that clothing does not come in contact with the petrol. If this happens, the clothing should be immediately changed.
- It is irresponsible and, thus, strictly forbidden to refill the tank in the vicinity of smokers or near an open fire.
- If fuel is swallowed or comes in contact with the eyes, consult a doctor immediately.

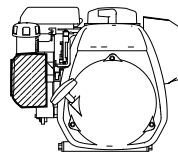
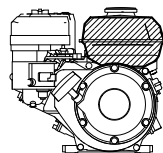

#### For your information :

For clear descriptions on the motor, consult the manual included.

### Checking, cleaning or replacing the air filter

A dirty air filter will block the airflow to the carburettor. To avoid disruptions, the filter should be cleaned off periodically. When working in an extremely dusty environment, the filter will need to be cleaned more often. Two items are also important to note.

- The filter may not become damaged, allowing unfiltered air to pass through the motor.
- The filter must permit enough air to pass through such that the air-to-fuel ratio stays optimally balanced for proper burning;

For this reason, it is necessary to regularly inspect the filter.

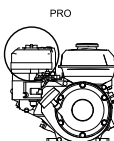
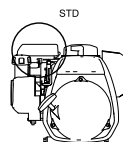

**Caution :**

Never allow the motor to run without an air filter, given that this will increase the rate of wear and tear on the motor. Allowing this to happen will render your manufacturer's warranty null and void.

- Checking the air filter on the Edge Styler STD.
- Remove the black cap (read § 6.2.) from the air filter.
- Do this by pressing on the locking tabs on the fuel tank side of the air filter cover.
- Remove the filter cartridge.
- Check for rips and tears.
- If the cartridge is torn or ripped, it should be replaced.
- Bang the cartridge carefully against a hard surface so as to remove any chunks of rubbish.
- If you have a compressed air blower available, you can clean off the cartridge by exposing the cartridge to a hefty burst of air while holding onto it.
- At the end of the cleaning session, be sure to put everything back how it was originally situated.

- Checking the air filter on the Edge Styler PRO.
- The Edge Styler PRO contains both a paper filter as well as a sponge filter.
- Loosen the black cap (read § 6.2.) on the filter.
- Also loosen the filter cartridge and pull it out of the motor.
- Pull the sponge filter elements up over and away from the paper elements.
- Check both for rips and tears; and replace, if necessary.
- Clean the paper air filter by gently by tapping it against a hard surface.
- Clean the sponge filter using warm, soapy water before rinsing and setting it out to thoroughly dry. Alternatively, clean it with a non-flammable cleanser and allow it to dry.
- Drench the sponge filter in clean motor oil and wring out the excess.
- If there is still too much oil in the sponge element, then this will cause the motor to pump out black smoke when it is used again.
- Put everything back in its original place and properly tighten both wing nuts.

**Caution :**

If a stream of compressed air is released too closely to the filter element, then this could cause micro-perforations that will render the filtering properties completely useless.

**Caution :**

If the machine topples over for some reason, set it again upright as quickly as possible! Since an overturned motor is an abnormal position for the motor, it is possible that oil from the crankcase has seeped through the carburettor and into the air filter. Since oil on a paper filter nullifies its porosity, allowing no air to filter through, it will be necessary to replace the filter if contaminated with oil.

## Checking the oil level

Lack of oil can cause considerable and irreparable damage to the motor. Oil that is contaminated and not replaced in a timely fashion can increase wear and tear on the motor. Regular check-ups will extend the life of the motor. Always follow the instructions provided in the motor manual.



### Warning :

The machines are designed for use on sloped planes. Hence, they do not have an oil level alarm. This also means that the machine does not have any safeguards to warn you against operation at low oil levels.

- Place the machine on flat ground.
- Pull out the dipstick from the motor and check whether the oil level has fallen below the minimum level. Usually, the oil level cannot be properly read so immediately.
- Thus, at first retrieval, wipe off the dipstick using a clean utility cloth, and put it back in without turning it. This will allow for the correct oil level to be read properly upon taking it out again,
- If the dipstick does not show any oil on it, or only shows oil at the tip, then oil should be added.
- The recommended type can be found in § 11.5.1.

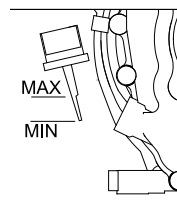

## Oil changes

- Preferably, this should be done when the motor is warm, since cold oil flows more slowly than when heated.
- Make sure that the machine is resting on flat ground and that the motor is switched off.
- Remove the cap on the spark plug.
- Have a receptacle with a minimum one-litre capacity on hand for catching the previously used oil.
- On the front side of the motor, underneath the motor base, there is a drain plug screwed into the crankcase. There is also a hole in the chassis, through which oil is able to flow.
- Place the bucket underneath this hole.
- Unscrew the bolt and let the contents of the motor empty out into the receptacle completely.
- After all of the oil has drained out, screw the drain plug back into the crankcase, and clean off any spilled oil with a clean utility cloth.
- Fill up the motor with 0.58 L of fresh oil (see §11.5.1.).
- Allow the oil ample time to flow through the cylinder block, all the way into the crankcase.
- Check the oil level using the dipstick (see §11.4.1.3.: Checking oil levels).
- Wipe away any spilled oil with a clean utility cloth.
- Replace the cap on the spark plug.

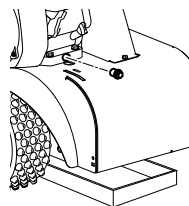



### For your information :

When draining off oil, a sufficiently large receptacle should be placed underneath the drain plug.

## Checking the spark plug

The spark plug is one of the most important parts for operating the motor. If the spark plug is dirtied or damaged, then this could seriously impact the starting of the machine as well as the capacity and efficiency of the motor.

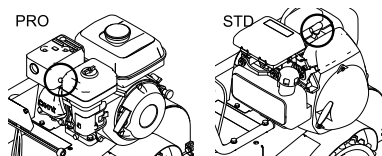

The motor manufacturer suggests using the following spark plugs for Edge Styler motors:

- NGK BPR6 ES (GX GC )
- DENSO W20 EPR-U



### Warning :

The spark plug and all motor parts in its vicinity become extremely hot during operation. To avoid the risk of burn injury, the motor should always be allowed to cool off. As a precaution, always wear utility gloves.

Periodic inspection is essential. This can best be done before using the machine. Otherwise, if it has just been used, allow the motor to properly cool off before checking the spark plug.

- The spark plug is located in the cylinder head of the motor (see § 6.2.).
- Pull off the cap of the spark plug.
- Clean off the area around the spark plug and rotate it out of the cylinder head (key size : Imperial 13/16 inches).
- Using a feeler gauge, check whether the distance between electrodes is 0,8 mm.
- If the spark plug is covered in deposits or is dirty, then it should be replaced.



To verify the ignition quality, the following steps should be taken when the spark plug has been removed:

- Put the spark plug cap back on.
- Grab the rubber part of spark plug cap and firmly press the outermost part of the electrode against the mass, meaning the cylinder block of the motor.
- Tug on the recoil starter cable a few times.
- Meanwhile, check for sparks between the two electrodes.

- If the spark is a clear, continuous, bright beam and is nicely centred between the electrodes, then the spark plug is still good.
- If the sparks is weak, irregular, and not as well-centred between electrodes, then the spark plug needs to be replaced.



#### Caution :

Putting in a spark plug, regardless of whether it is old or new, should be done with the utmost caution, so that the screw thread in the cylinder head certainly does not become damaged. Secure the spark plug with a torque of 20 Nm. A loose spark plug can cause the motor to become overheated and inflict damage.

Screwing in the spark plug too tightly could damage the screw thread in the cylinder head.

### 11.4.2. Machine maintenance

Always take care that the space being used for performing maintenance is properly suitable in accordance with the recommendations as described in § 11.1.

#### Removing protective coverings

The Edge Styler STD as well as the Edge Styler PRO each have three different types of protective coverings.

- Cover for the blade carriage.
- Cover for the blade transmission.
- Cover for the foot pedal.

These should be loosened depending on the maintenance procedure.

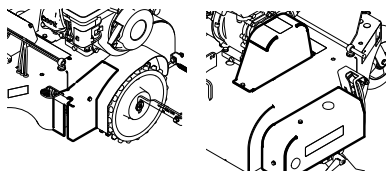

- Cover for the blade carriage.
  - Make sure the motor is off and that the blade carriage is in transport mode.
  - Using a wrench (number 10), the three bolts holding on the cover should be removed.
  - Remove the cover by first sliding it away from the machine, followed by an upwards motion.
- Cover for the blade transmission.
  - Make sure the motor is off and that the blade carriage is in transport mode.
  - Using a wrench (number 10), the two bolts holding on the cover should be removed.
  - Remove the protective cover.

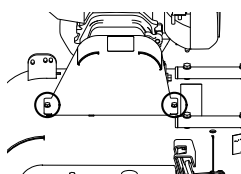
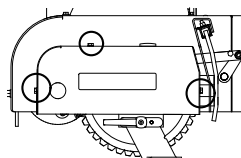

- Cover for the foot pedal.
- Make sure the motor is off and that the blade carriage is in transport mode.
- Using a wrench (number 10), the bolt on the side of the cover should be removed.
- Push the cover slightly downwards so that the clip underneath the chassis comes loose.
- After that, pull the cover slightly backwards so that the clip above the traction tyre also comes loose.
- Remove the protective cover.

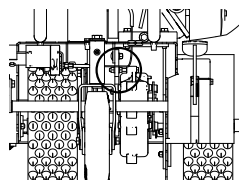

### Safely tipping the machine

In some maintenance procedures, you will work on the underside of the machine. When doing this, the machine should be tipped over and supported in a safe manner.

- Make sure that you are standing approximately 50 cm from a wall.
- If preferred, cardboard may be placed underneath the machine, which will protect your floor as well as avoid scratches on the machine.
- Tip the machine over its traction tyres so that it touches the ground at the front side of the chassis.
- Continue to press the machine forward until it is resting against the wall.
- Be careful that the dead man's handle does not become clenched.
- Reposition the machine as necessary.

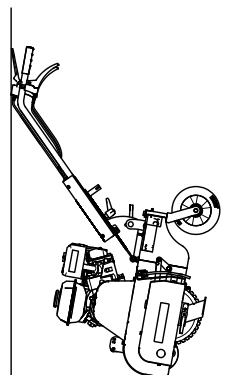

#### Warning :

The machine may only be tilted forwards. Tilting the machine in any other direction can cause motor fluids to flow through to other parts of the motor, which can lead to further damage to components of the motor.

### Tightening the belts

The Edge Styler is equipped with two belts. Both belts can become overstretched and show signs of wear and tear after multiple uses. Even breakage can occur. If a belt becomes broken, it should be replaced at an ELIET authorised dealer. If overstretched, the belt can be re-tightened by following the procedures below.

- Tightening the blade driver belt.
- Make sure the motor is off and that the spark plug has been disconnected.
- Remove the protective cover from the blade carriage (read § 11.4.2.1. ).
- Under the cover, there is an extension spring connected to the connector rail.
- Disconnect the spring from the connector rail and reconnect it again, this time farther down

the rail.

- If the belt tension is still inadequate, repeat the above procedure.



**Caution :**

You may not have much space to carry out the aforementioned procedure. If this is indeed the case, then you could remove the entire blade carriage to create more space. Do this at your own risk however. Otherwise, contact an authorised ELIET dealer.

- Tightening the wheel drive belt.
- Tip the machine over (read § 11.4.2.2.).
- Place the transmission box underneath the machine (read § 6.1).
- The top of the transmission box is connected to the chassis with a single nut, sitting in a slot.
- Loosen this bolt, so as to be able to remove the transmission box.
- To re-tighten the belt, pull the transmission box towards you, and screw in the bolt completely.

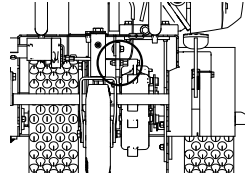

**Check for excessive looseness**

The jabbing motions made by the Edge Styler makes the machine susceptible to jolting and jarring. After several hours of operation, this could cause increased wear and tear on a number of moving or rotating parts. This causes these parts to become loose, which affects the functioning and life of the machine and can create a safety hazard for the operator. Thus, periodic checks for excessive looseness are necessary.

Parts undoubtedly subject to inspection are :

1. Looseness at the hinge of the blade arm
2. Looseness at the coaxial shaft
3. Looseness at the eccentric bearing
4. Looseness at the blade carriage guide
5. Looseness or damage to the pedal
6. Looseness of the axles

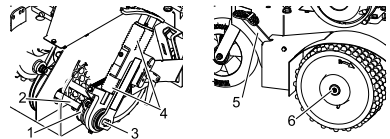

For this, perform the following checks :



**Caution :**

In order to perform these checks, the motor should be switched off; and the spark plug, removed. Also wear the appropriate safety gear.

- Checking for looseness at the hinge of the blade arm.  
To switch the blade arm from transport mode to operating mode, turn it around a central axle. In order to keep the rotation silent, with no screeching, the hinge was equipped with two, large, nylon axle bearings.  
The nylon creates a lubricating effect and has a high toughness, making it resistant to wear



and tear. Nevertheless, these nylon axle bearings still may exhibit signs of looseness over time. Convert the blade arm to transport mode. Grab hold of it at the height of the pinion and try to move it back and forth along the width of the machine. If there is no more leeway in the movement, then the nylon axle bearings are still in good shape. If the upper part of the blade arm can be shifted more than 10 mm, then the nylon axle bearings would be showing significant signs of wear and tear and would need replacing. Consult your authorised ELIET dealer for more information.

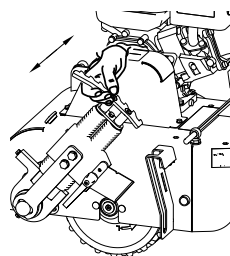

- Checking for looseness at the coaxial shaft.  
This axle drives the eccentric and, thus, is impacted by the jarring. This axle can exhibit signs of both axial and radial looseness. Hence, both of these directions require checking. For this, remove the protective cover from the blade guide (read § 11.4.2.1). Convert the blade arm to transport mode. Grab onto the cylindrical part and try to move it radially, back and forth, to determine whether there is any looseness.

Tip the machine forward until it is supporting itself by the housing (read § 11.4.2.2). This makes it easy to reach the components under the bottom of the machine's housing. Next, grab hold of the belt disc and try to move it axially, back and forth, to determine whether there is any looseness. If any looseness is detected, go to your nearest, ELIET authorised dealer to replace any bearings or perform any necessary repairs.

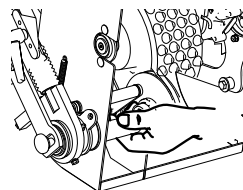

- Checking for looseness at the eccentric bearing.  
In order to convert rotary into linear reciprocating motion, the eccentric bearing fits into a notch on the piston rod. Hence, the bearing makes a rotating and gliding motion.

To determine if there is any looseness, then the blade guider's cover should also be removed (read § 11.4.2.1.). See if the piston ring of the piston rod exhibits signs of wear and tear.

Check whether the tightening bolt that attaches the bearing to the coaxial shaft is still firmly in place (Allen key 5). The normal tolerance between piston ring and bearing jacket is not visible to the naked eye under normal circumstances. Try moving the piston rod to be sure this has not become more excessive. If any excessive looseness is found, then both the piston rod and the bearing will need replacing. Consult your authorised ELIET dealer for more information.

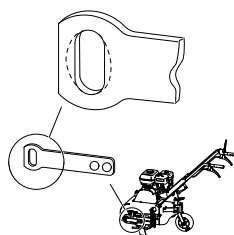

- Checking for looseness on the blade carriage  
The blade carriage glides back and forth on two axles. To minimize

wear and tear on the blade carriage, it is equipped with three special guide bearings. These axle bearings are manufactured from a special alloy with lubricating properties. A failure to lubricate or keep the bearings clean can cause them to erode. In order to properly gauge whether there is any potential looseness, the cover will require removal (read § 11.4.2.1.). Convert the blade arm into transport mode.

Rotate the coaxial shaft until the eccentric bearing is well centred in the piston ring of the piston rod. Grab onto the piston rod and blade holder and try to move it left and right, to determine whether there is any looseness. Additionally, underneath the blade holder, try to angle it forwards and backwards to identify any lateral looseness present on the carriage guide. Check whether the four bellows, which should impede dirtying of the axles, are still firmly attached and show no signs of damage. If you notice any damage to the bellows, they should be replaced. If any excessive looseness is found, then see your nearest authorised ELIET dealer to have the guider's axle bearings replaced.

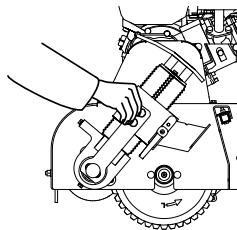

- Checking for looseness or warping of the foot pedal.

The foot pedal is for switching the blade from transport mode to operating mode. There is proper procedure for this which must be followed (read § 9.4.2.). If this procedure is not followed, however, and you carelessly use all of your might and body weight to force down the pedal, then the pedal could become malformed and the ratcheting mechanism coupled with it could also become damaged. To determine whether the pedal is worn or damaged, the black cover should be removed (read § 11.4.2.1.). Thereafter, check whether any parts have become bent or malformed. Also check the weld joints. If anomalies have been found, then consult an ELIET authorised dealer immediately for having the necessary parts repaired.

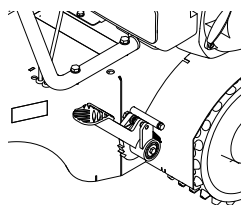

- Checking for looseness at the wheels.

The wheels are powered by a transmission box inside the lower part of the machine. Each of the two traction wheels are heavy (16 kg/st) and rotate on axles via a roller bearing. These axles are tempered locally to prevent the axles from wearing down. If the roller bearings become considerably worn, then the wheels will begin to slip on the axles during operation, which will result in a loss of traction. For this reason, check whether there is any looseness present along the radial axis.

To access the wheels easily, the machine will need to be tipped over again such that it is supported on the ground by the housing (read §11.4.2.2.).

Now, check to see whether there is any excessive looseness by at-

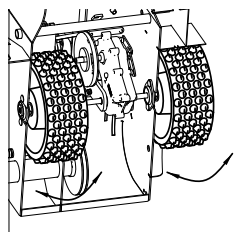

tempting to tilt the wheel back and forth on the axle.

If this is the case, then consult an ELIET authorised dealer for carrying out the necessary repairs.



**Caution :**

After having completed any checks, always remember to place the covers back on to where they were originally mounted.

**Blade (dis)assembly**

For inspecting the blade, the blade mount, and blade sharpness, the blade needs to be taken off.

- Ensure that the motor is off and the spark plug, disconnected.
- The blade sits in place with a handle and two clamping plates.
- Rotate the handle completely loose.
- Remove the blade and the clamping plates.
- Upon assembling the blade, first place the back side of the clamping plate back onto the blade holder. Slide the three pins through the holes of the blade holder.
- Afterwards, place the blade and the foremost clamping plate on the mounting pins of the rear clamping plate.
- Tighten everything by rotating the handle on the middle mounting pin again.
- Be sure that everything is tightly in place.
- If the handle is pointing downwards after tightening, then pull it out and put it in again in an upwards position.

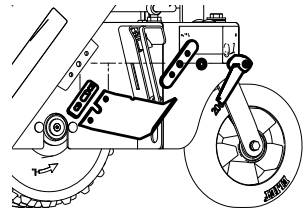

**Checking the blade and blade mount**



**Caution:**

In order to perform these checks, the motor should be switched off; and the spark plug, removed. Also wear the appropriate safety gear.

- During operation, the blade makes approximately 1000 jabs per minute. This means that both the blade and the blade mount are subject to an intense amount of jarring. Jarring is a primary cause of wear and tear and operator fatigue.
- In the interest of preserving the machine's lifespan, and safety of the operator and others, it is essential to check the condition of the blade and blade mount every time the machine is employed.
- The blade is affixed onto the blade carriage with two pins. Naturally, this would explain the two holes on the end of the blade.
- The blade is secured onto the pins by tightening it firmly against the blade carriage with a central bolt and clamping plate.

- Regular stops should be made during work sessions to ensure that the tightening bolt is still properly screwed on. This bolt was made so that it can be tightened without the use of any tools.
- Disassemble the blade (read § 11.4.2.5.). It is important to check whether the two pins are not worn down. The blade should also be checked to ensure that the holes at the end of the blade did not become oval.
- If necessary, the pin plate and blade should be removed completely. Order these parts from an authorised dealer (pin plate order code: MPA 01 121 040).
- Additionally check to make sure the screw thread of the mounting bolt is not damaged. A damaged or dirty screw thread could give rise to inadequate tension being able to be exerted on the blade restraint.
- Check to ensure that the blade does not exhibit any signs of bending or defects.
- Due to all the scraping into the ground, the steel alloy can wear off in some areas, making the blade's thickness slightly less. If the blade becomes less than 2 mm thick, then it should be replaced to avoid breakage.
- Check whether the edge of the blade is still sharp enough. If the edge has become dull, then it should be sharpened prior to using it again (read § 11.4.2.7. ).

### Sharpening the blade

While operating the machine, the blade chops its way through the ground. All sorts of obstructions also get in the way during this process; not to mention, the blade is also susceptible to the eroding effects of sand and dirt. As previously described, the resistance against the blade is a crucial factor for the proper functioning of the machine. A sharp cutting edge is, therefore, essential.

- Inspect the blade regularly.
- For this, switch the blade arm into transport mode. Always switch off the machine.
- A new blade will have a sharp, frontal cutting edge (the slicing side). The angle of the cutting edge is approximately 20°.
- Due to how the blade works, the sharp angle of the cut will become rounded off or fatten out to a wider edge (1). If this is noticed, then the blade must be sharpened.
- For this, disassemble the blade (read § 11.4.2.5.).
- Clamp the blade into a vice.
- The blade can be sharpened using an angel grinder.

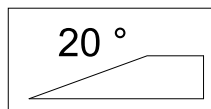

#### Caution :

Always wear protective eyewear to shield the eyes from projectile objects.

**Warning :**

Lit sparks will fly around when grinding the blades. They may start a fire. Bear this in mind when selecting the work site. Never grind blades near fuel or lightly flammable products.

- By grinding a little metal from the cutting edge, you can again obtain a sharp cutting edge from this wide rib. (2)
- Grinding is performed by moving the grinding disc along the angled cutting edge.
- Note: By regularly grinding, you will only have to grind away a small adjustment of the metal each time to again obtain a sharp cutting edge. This will ensure for very short grinding times and you will always have the best possible cutting edge (ELIET recommends the following: Every 10 working hours)
- Avoid grinding at the same location for a longer period of time. this will prevent local discoloration of the blades, which would indicate heating and, therefore, the material structure at these places will change and the hardness will decrease.
- It is extremely important that the existing cutting angle be respected when grinding. (3 : Incorrectly ground blade)
- If the cutting angle is not maintained, blades will be stopped due to a blunt angle (4) or an interrupted cutting angle (5) and a lot of power will be lost. Too sharp a cutting angle (6,7) will give rise to a weakened cutting edge and, therefore, blade life will be considerably shortened (see figures 4, 5, 6 en 7).

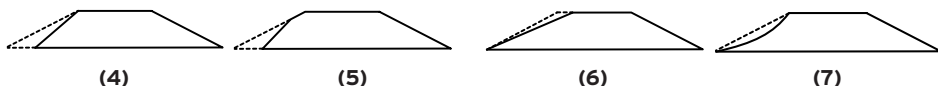
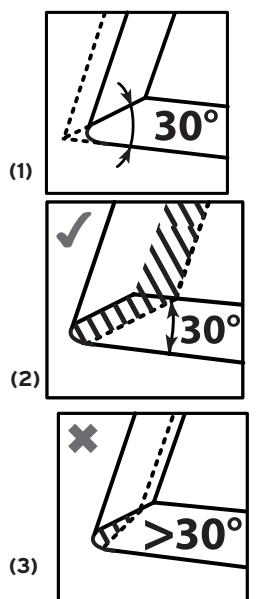

Sharpen the vertical and (if present) the horizontal cutting edge.

The crease does not need to be sharpened. This would weaken the blade considerably or could cause notching.

**Caution :**

First allow the blade to cool off after a sharpening session so that you do not burn yourself on the heated cutting edge.

After sharpening the blade, it should be carefully remounted onto the machine (read § 11.4.2.5.).

**Readjusting cables**

The cables should be readjusted if your machine no longer responds properly to the operator controls at the handle, whilst having already inspected the belts for the proper tension.

If the blade carriage no longer smoothly converts into transport mode.

If the motor intermittently does not want to start up.

If the accelerator on the PRO no longer responds as it should.

To get the machine back into prime shape, the cables should be tightened. This process is similar to tightening the braking cables of a bike

- Rotate the cable somewhat loose at the handle.
- This can be done by twisting out the bolt somewhat.
- This will lengthen the cable holder and adds a bit more tension to the cable itself.
- Next, secure this bolt back into place by rotating the clamping nut until it is as close to the handle as possible.

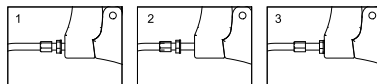

## 11.5. General lubrication treatment

---

ELIET is committed to using high-quality materials so as to keep the machines durable in what sometimes can be rather extreme working conditions. For this reason, special lubricants have always been used, even from the moment the machine comes from the factory. ELIET also recommends lubricating all the parts on a regular basis. Lubrication treatment is pertinent given that this Edge Styler is often employed in heavily tasking situations and dusty conditions.

### 11.5.1. Lubricants

---

- Motor, 0.58 L, Mobil SAE 10w-30 API SF / CC
- Lubricating nipples, Sunoco MULTI PURPOSE LR-EP2
- Hinges
  - Novatio White supreme grease
  - Novatio PFT
  - Novatio Clearlube
- Spark plugs
  - NGK BPR 6 ES
  - DENSO W20EPR-U

### 11.5.3. Thorough lubrication using the nipples included

---

The Edge Styler STD/PRO comes with 6 lubricating nipples.

- 1 per traction wheel
- 2 on the blade carriage
- 1 hinge on the blade carriage, underneath

- 1 on the swivel caster

In order to lubricate these nipples, you should have a grease dispenser at your disposal. If these are not available to you, there is always the option of visiting an ELIET dealer for maintenance.

- To lubricate the lubricating nipples, first clean them off and remove all the old grease.
- If necessary, remove the cover from the blade carriage. The lubricating nipples can also be accessed by switching the blade carriage into transport mode and removing the uppermost rubber cap.
- Spray on new grease in the lubricating nipple using an altered grease dispensing lever.
- For this, use the Sunoco MULTI PURPOSE LR-EP2.
- One or two pumps should be sufficient.
- Remove any excess grease.

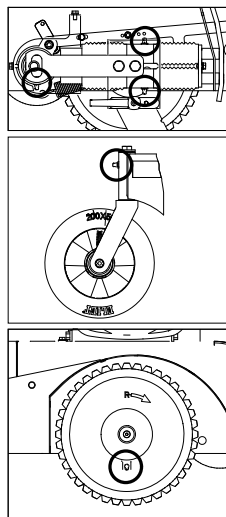

### **11.5.2. Lubricating hinges and contact points prone to friction**

- Remove the protective caps, where necessary, to access any hinges or contact points prone to friction (read § 11.4.2.1.).
- Where possible, disassemble the hinge or joint.
- Spray the chafing parts with a molybdenum disulphide ( $\text{MoS}_2$ )-based penetrating oil, and allow it to seep in evenly.
- Wipe off all the old excess grease and other gunk sticking to the area.
- Use compressed air to get rid of all the other gunk in harder-to-reach areas between the hinge joints.
- Once the hinges are clean again, apply new lubricant. Spray lube in the joints between the two friction surfaces.
- ELIET recommends Novatio Clearlube as the lubricant of choice for hinges. For contact points prone to friction, however, Novatio PFT is suggested.
- Always wipe away any excess lubricant.

### **11.3.4. Lubricating the bearings**

Most of the Edge Styler STD/PRO's bearings are closed bearings and, thus, difficult to lubricate. Bearings that are still easy to lubricate are the following:

- Bearing on the swivel caster.
- Eccentric bearing, accessible by removing the rubber covering from the side of the cap protecting the blade carriage.
- The blade carriage bearings and belt tensioner under the cap protecting the blade carriage (§ 11.4.2.1).
- Bearings for the foot pedal (§ 11.4.2.1).

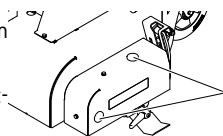

**Caution:**

Always clean off the machine before lubricating treatments. Lubricating a dirty machine will force rubbish into the bearings and will increase the amount of wear and tear.

- Where necessary, remove the protective coverings (read § 11.4.2.1.).
- Clean off the bearings requiring lubrication.
- Spray a bit of MoS<sub>2</sub>-based penetrating oil on the axis of the bearing.
- Wait briefly.
- Spray once again.
- Let the bearing rotate for a moment. If the bearing can do this on its own when the motor is running, then do it as long as you are alert for safety.
- Remove any excess grease.



## 12. Winterizing the machine

---



When stowing away the machine for extended periods of time, it is recommended to follow the steps below:

- Clean the entire machine thoroughly.
- Give the Edge Styler a major overhaul.
- Make sure the engine is completely drained of fuel: run the engine until the fuel tank and the carburettor are out of fuel and the engine stops. Alternatively, siphon the fuel off from the engine's tank into an approved container.
- Remove the sparking plug (see § 11.4.1.5.: Checking the sparking plug).
- Spray a little amount of MoS<sub>2</sub>-based penetrating oil into the cylinder.
- Slowly pull the starter cord until the engine is about to crank to allow the oil to cling to the internal surfaces of the cylinder. Refit the sparking plug finger-tight.
- Touch up all unpainted areas or wipe the entire machine with an oiled rag to protect all metal surfaces.
- Touch-up paints/lacquers are available from your ELIET dealer.
- Store the machine in a cool, dry and protected location. If necessary, place a protective covering (sailcloth, for example) over the machine.
- Avoid rain/water from splashing on the machine.
- At ELIET, we recommend to store the Edge Styler in a ventilated, dry and protected location.
- Never store the machine in a place where it could be exposed to an open flame.
- Always allow the motor time to cool off prior to covering it with tarp.

## 13. Extra equipment



Edge Styler STD: As an extra, the styler can come with an anti-deviation disc, which aids in the operation of the machine. This disc is best installed by the dealer, as you would mainly need to take off the entire wheelbase. Having the dealer do this eliminates the risk of bending the axles and damaging the transmission box.

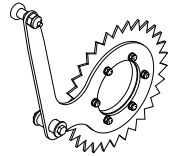

Style blade for laying cable Robomower WD 5 CM  
BU 104 104 202

This is a blade that is used for making a line of demarcation for an automatic lawn mower at a depth of 5 cm.  
This blade goes together with the optional wiring kit.

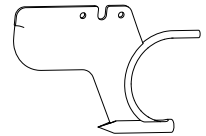

Style blade for laying cable Robomower WD 7 CM  
BU 104 104 203

This is a blade that is used for making a line of demarcation for an automatic lawn mower at a depth of 7 cm.

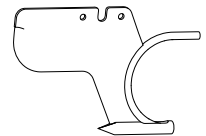

STANDARD BLADE TYPE 1V WD 2 CM  
BU 104 100 100

This is a blade that is used for styling an open lawn edge.  
This blade will shape the vertical as well as horizontal edge of the lawn.  
The wing extension on the blade ensures that the styled sod is diverted and cast to the side. Work depth 2 cm

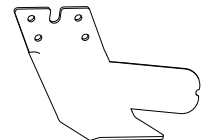

STANDARD BLADE TYPE 2V WD 4 CM  
BU 104 100 200

This is a blade that is used for styling an open lawn edge.  
This blade will shape the vertical as well as horizontal edge of the lawn.  
The wing extension on the blade ensures that the styled sod is diverted and cast to the side. Work depth 4 cm

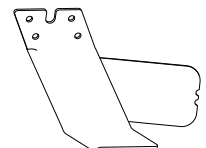

**STANDARD BLADE TYPE 3V WD 6 CM**

BU 104 100 300

This is a blade that is used for styling an open lawn edge.

This blade will shape the vertical as well as horizontal edge of the lawn.

The wing extension on the blade ensures that the styled sod is diverted and cast to the side. Work depth 6 cm

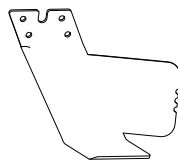
**ANGLED BLADE TYPE 1V WD 2 CM**

BU 104 103 100

This is a blade that is used for creating extra space between a terrace and the lawn edge. The vertical part of the blade slides along the base of the terrace and chops away the sod from the lawn edge.

Work depth 2 cm

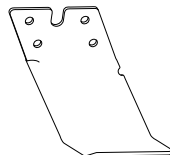
**ANGLED BLADE TYPE 2V WD 4 CM**

BU 104 103 200

This is a blade that is used for creating extra space between a terrace and the lawn edge. The vertical part of the blade slides along the base of the terrace and chops away the sod from the lawn edge.

Work depth 2 cm

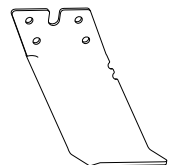
**ANGLED BLADE TYPE 3V WD 6CM**

BU 104 103 300

This is a blade that is used for creating extra space between a terrace and the lawn edge. The vertical part of the blade slides along the base of the terrace and chops away the sod from the lawn edge.

Work depth 2 cm

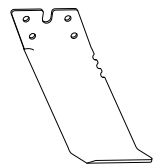
**STRAIGHT BLADE WD 4 CM**

BU 104 101 100

This is a blade used for making vertical cuts, often for making a gap between the terrace and the lawn once again.

Work depth 2 cm

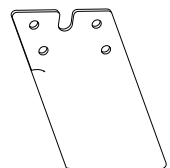
**WALKWAY BLADE EDGE STYLER WD 3 CM**

BU 104 104 100

This blade is extremely suited for working around the edges of terraces and footpaths. It cuts away sod and lifts it from the ground.

Work depth 3 cm

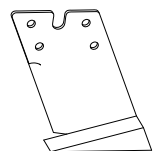

**U-BLADE 35 MM WD 5 CM**

BU 104 102 100

This is a blade that is most appropriate for laying shallow cable or irrigation networks in the lawn. Sod that is chucked away can be reseated back into the gap so that the dig almost appears as though it never happened. Work depth 2cm / width 3,5 cm

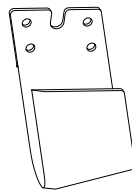
**U-BLADE 50 MM WD 5 CM**

BU 104 102 200

This is a blade that is most appropriate for laying shallow cable or irrigation networks in the lawn. Sod that is chucked away can be reseated back into the gap so that the dig almost appears as though it never happened. Work depth 5 cm / width 5 cm

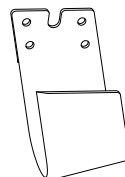
**STANDARD BLADE TYPE 4V WD 8 CM**

BU 104 100 400

This is a blade that is used for styling an open lawn edge.

This blade will shape the vertical as well as horizontal edge of the lawn. The wing extension on the blade ensures that the styled sod is diverted and cast to the side.

Work depth 8 cm

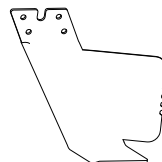
**STANDARD BLADE TYPE 5V WD 10 CM**

BU 104 100 500

This is a blade that is used for styling an open lawn edge.

This blade will shape the vertical as well as horizontal edge of the lawn. The wing extension on the blade ensures that the styled sod is diverted and cast to the side.

Work depth 10 cm

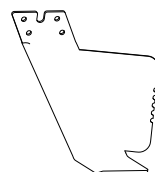
**GOLF BUNKER BLADE -WD130/150**

BU 104 103 400

This is a blade for edging up lawn surrounding a golf bunker. This blade will shape the vertical as well as horizontal edge of the lawn. The wing extension on the blade ensures that the styled sod is diverted and cast to the side.

Work depth 13 cm

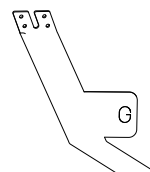

## 14. Hazard analysis

---

Below you will find a list of dangers and risks that are linked to using the Edge Styler. This list is merely a summary and is not exhaustive. When working with a machine that poses potential hazards, precaution should be exercised under all circumstances. You eliminate danger if you act responsibly, given all the potential dangers. Take note of the hazards described in the manual and keep safety measures in mind.

Neglecting to do so will be hazardous to you as well as your surroundings.

- Ensure that bystanders are always kept at a safe distance.
- Removing covers that shield parts connected to rotating belts introduces the risk of fracture, entanglement, or severing of fingers or other limbs.
- Reaching underneath the machine while the motor is running also introduces the risk of fracture, entanglement, or severing of fingers or other limbs.
- There is the risk of bruising or becoming wedged between the steering rack and an obstacle whilst moving in reverse or turning direction.
- Injuries caused by the machine tipping due to unsafe transport.
- Physical injury can occur when traversing ground that cannot support the weight of the machine.
- Risk of electrocution comes into play when pulling high voltage cables away from the spark plug whilst the motor is on.
- Heat exhaust or heat from the motor can cause scorching.
- Rubbish build-up around the exhaust or poor cleansing of the motor creates a fire hazard.
- Petrol spills also create a fire hazard.
- Heavy inhalation of petrol vapours can induce intoxication.
- Heavy inhalation of exhaust fumes can induce intoxication.
- Air passages and the lungs are prone to irritation if breathing in dust particles produced during operation.
- Noise-induced hearing loss can arise when the proper ear plugs or hearing protection is not used during operation.
- Nerve damage or rheumatic disease can develop when exposed to the jarring for too long, without pausing for breaks.
- Back problems caused by lifting the machine in an irresponsible way.
- ...

# 15. Warranty conditions

Dear Customer,

We thank you for purchasing an ELIET product. Congratulations on your purchase of this machine which is sure to meet your expectations and needs over the coming years. At ELIET, we do everything to ensure that our products function correctly. That is why your product qualifies for a two year guarantee.

## What is warranty ?

At ELIET, we have strict quality rules on designing and manufacturing products. The priorities given by these rules are to guarantee a long service life and permanent safety. That is why at ELIET, we are willing to repair at no charge hidden defects or faults during the whole run-in period (aka the warranty period), provided the prescribed procedure is followed.

## Warranty conditions

ELIET's warranty obligations for new machines is governed by the following conditions.

### **I. Warranty period**

The warranty period starts the day the dealer delivers the machine to the customer (maximum one week after the purchase) and expires :

- after two years of private use.
- after twelve months or 100 running hours of rental use.
- after twelve months or 100 running hours in semi-professional or in professional use.

To be eligible to obtain warranty the customer is invited to register the newly purchased machine with ELIET. You should complete the registration card online on Eliet's website : [www.eliety.eu](http://www.eliety.eu).

If you don't have access to the Internet, please complete the attached registration card in its entirety and return it to ELIET.

### **II. What is covered by the warranty ?**

- Wear items are not covered by the warranty conditions : (such as blades, bearings, belts, chains, gearwheels, tyres, bulbs, fuses, etc).
- If failures are found to be caused by improper use, neglect or consequential damages by an external source (fall, chippings, foreign objects, accident).
- If failures are found to be caused by improper maintenance of the machine, that is not in accordance with the prescribed periodic maintenance.
- When a defect is caused by improper repair made by anyone other than an authorized ELIET dealer or after using not genuine Eliet service parts.
- When the defect is caused by making improper changes to the original design of the machine.
- When the fault develops when the machine has been used not in accordance with the instructions contained within this manual.
- When the prescribed warranty procedure has not been adhered to or when the warranty pe-

riod has expired.

- For all problems relating to the motor, please contact an authorized service centre of the engine manufacturer.

### III. Procedure

- **Step 1 :** On the date of purchase, the customer should register his/her purchase online by completing the registration card at [www.elieta.eu](http://www.elieta.eu). In addition, the enclosed registration card should be completed in its entirety on the day of purchase. The first part of the form should be returned to ELIET within one month. The customer should keep all remaining parts of the card along with the purchase invoice for the duration of the warranty period.
- **Step 2 :** In the event of a defect becoming apparent, the customer shall have this verified by the authorized ELIET dealer. If the dealer feels that there is a factory defect, the dealer may invoke the warranty, under the terms specified.
- **Step 3 :** Every warranty application must be accompanied by a fully completed official application form. Copies of this warranty application are available to dealers at ELIET or even at an importer/agent.
- **Step 4 :** The dealer then orders the parts needed to perform the repairs. Next, the dealer faxes the order form together with the completed warranty form and a copy of the registration card.
- **Step 5 :** The warranty form should be stapled to the purchase invoice and mailed to ELIET or an importer/agent of ELIET.
- **Step 6 :** ELIET will send the parts ordered to the dealer under the regular delivery and payment conditions.
- **Step 7 :** The defective part will be examined by the technical department first prior to approving or rejecting the warranty. ELIET reserve the right to solely decide whether or not the customer has complied with the conditions for the validity of this guarantee, i.e. 1 year or 2 years. Faulty components shall become the property of ELIET.
- **Step 8 :** When a warranty claim is found to be valid, ELIET will credit the warranty parts. Customers shall never be entitled to apply for a refund of labour costs.

### IV. In case of damage caused by transport

- All goods are supplied ex factory. Transport risks are borne by the customer. It follows, that ELIET highly recommend to check the goods for damage on arrival.
- Any damage found should be stated on the delivery form before signing. Make sure the driver of the haulage company puts his signature next to the damage on your copy.
- In the absence of a written and signed declaration on the delivery form, the insurance of the haulage company will not accept any liability.
- Damages can be claimed from the hauler using a copy of the delivery form and a covering letter stating your complaint.
- The damaged machine should be kept in its original condition until the hauler's insurer has performed any examination.

**REGISTRATIONCARD****ELJET CUSTOMER SERVICE**

To be able to claim the full rights to what you are entitled to, it is important to register within a month after the date of purchase. To be able to fill out the registration form and get in the best registration order to the ELJET Customer Service, your purchase should be registered on the ELJET website [www.eljet.be](http://www.eljet.be).

**REGISTRATIEKAART****ELJET KLANTDIENST**

Om de volledige rechten te kunnen maken op wat u gerechtigd bent, is het belangrijk om uw aankoop bij ELJET te registreren. Het is belangrijk om uw aankoop te registreren op de website van de registratiedienst van de ELJET klantendienst. Het is belangrijk om uw aankoop op de ELJET website [www.eljet.be](http://www.eljet.be) te registreren.

**CARTE****SERVICE**

Pour pouvoir bénéficier de tous les droits auxquels vous êtes éligible, il est important de déclarer votre achat à ELJET dans un délai d'un mois après l'achat. Pour pouvoir remplir le formulaire de déclaration et être en première ligne auprès du Service Clientèle ELJET, votre achat doit être enregistré sur le site Internet de ELJET [www.eljet.be](http://www.eljet.be).

**ELJET**

Registratiekaart  
Carte de Service Clientèle  
Registrationcard

ELJET Customer Service  
Zandweg 134  
B-4500 Geopunt  
België

**Customer Identity / Identiteitsgegevens / Données du Client / Kundendaten**

Name / Naam / Nom / Nome		District / District / District / Arrondissement	
Title / Titulo / Titulo / Titulo		Street / Rue / Rue / Calle	
Street / Ruelle / Feld / Field / Field		Country / Pays / País / País	
Municipality / Mairie / Municipio / Municipio		Zip / Code / Código / Código	
Phone			

**Machine Identity / Machinegegevens / Données de machine / Daten Maschine**

Model / Model / Modelo / Modelo		Year of manufacture / Année de fabrication / Año de fabricación	
Serial number / Numéro de série / Número de serie		Registration number / Numéro de registre / Número de registro	
Date / Date / Fecha / Fecha			
Signature / Signature / Firma / Firma	Stamp of dealer / Marque du marchand / Sello del comerciante / Marca del distribuidor		
Signature / Signature / Firma / Firma	Stamp of dealer / Marque du marchand / Sello del comerciante / Marca del distribuidor		

De informatie die u op deze kaart invult, wordt gebruikt om uw aankoop te registreren en om u te helpen bij het claimen van uw rechten. Het is belangrijk dat uw gegevens nauwkeurig worden ingevuld. Het is belangrijk dat u de dealer die u heeft gekocht aanmeldt en dat u de informatie die u op deze kaart invult, registreert op de website van de registratiedienst van de ELJET klantendienst. Het is belangrijk dat u uw aankoop op de website van de registratiedienst van de ELJET klantendienst registreert.

This document has to be filled in within a month after purchase.

Se este documento, de devolva-lo imediatamente ao vendedor, para que possa registar a sua compra e obter os benefícios que lhe são devidos. É importante que o documento seja preenchido com os dados corretos e que seja registado no site Internet do Serviço ao Cliente ELJET.

- Particulier / Particulier particulier / Particulier particulier / Privado / Particular  
 Profession / Profession / Profesion / Profession / Gewerkschaps / Gewerkschaps  
 Totaire / Total / Total / Total / Total / Total  
 Public / Public / Público / Público / Öffentliche / Öffentliche / Öffentliche  
 Retail / Retail / Retail / Retail / Retail / Retail

Dit document dient binnen de maand na aankoop teruggeleverd te worden naar de ELJET Klantendienst.

This document has to be returned to ELJET Customer Service within a month after purchase.

Retornez ce document au Service après-vente ELJET dans le mois suivant à la date d'achat.

Dieses Dokument muss innerhalb eines Monats nach Kaufdatum an den ELJET Kundendienst zurückgeschickt werden.



# 16. EC-declaration of conformity



Machine: **EDGE DRESSER**  
Type: **ELIET EDGE STYLER**  
Model number: **MA 022 010 201**  
**MA 022 020 203**

The previously mentioned machine has been designed and manufactured to comply with the following European CE regulations :

## **EN 786 - GARDEN EQUIPMENT - ELECTRICALLY POWERED WALK-BEHIND AND HAND-HELD LAWN TRIMMERS AND LAWN EDGE TRIMMERS - MECHANICAL SAFETY**

ELIET mfg. cy. hereby declares that after performing a hazard analysis, it is fully aware of the potential hazards and risks associated with the machine. In this knowledge, the necessary steps have been taken in line with Machine Directive 2006/42/EC in order to ensure absolute operator safety for the operator, when the machine is used correctly.

The value of the measured sound power level and the guaranteed sound power level were obtained according to the procedures set forward in the directive 2000/14/EG annex III/B clause 24 and directive EN 786.

Measured sound power level LwA : 93 dB(A)  
Guaranteed A-weighted sound power level : 94 dB(A)

Date: 01/01/2011

Signature:

A handwritten signature in black ink, appearing to read 'Frederic LIETAER', written over a horizontal line.

Frederic LIETAER  
Managing Director ELIET EUROPE NV  
Date of birth: 02/01/1975

ELIET EUROPE NV  
Diesveldstraat 2  
BE - 8553 Otegem Belgium  
Ph. +32 56 77 70 88 - Fax +32 56 77 52 13  
info@eliet.eu - www.eliet.eu

# 17. Equipment specifications



	STD	PRO
Motor	4,0 pk Honda GC135	5,0 pk Honda GC160
Power KW/PK DIN	2.7/3.7	2.6/3.5
<b>Maximum speed</b>	2800 t/min	2800 t/min
<b>Efficiency (Meters/hour)</b>	900	900 tot 2000
Blades	§13 Extra onderdelen	
Storage dimensions (LxBxH)		
Nominal dimensions	1250 x 540 x 915 mm	
Weight	82 kg	94 kg
<b>Wheel drive</b>	260 x 100 mm	260 x 100 mm
<b>Single wheel</b>	200 x 50 mm	200 x 50 mm
Petrol tank	1.3L	2.0L
Sound power Lw(A)	94 dB(A)	94 dB(A)



